

CONTROL YOUR WORLD



**TOPCON**

Precision Agriculture

**09**

**COMPONENTS CATALOGUE**



## Pumps

- Semi-Hydraulic Boom Sprayer Pumps ..... 2
- High Pressure Pumps ..... 3
- Vineyard / Orchard Pumps ..... 4
- Piston Pumps ..... 5
- High Pressure Controllers ..... 5

## Control Systems

- Electric Valve Systems ..... 6

## Valves & Valve Sets

- Valve Sets ..... 7
- Valve Sets with Electromagnetic Flowmeter ..... 8
- Replacement Valves ..... 9
- Flow Control Valve ..... 10
- Manual Section Valves ..... 10
- Pressure Relief Valves ..... 10
- Motorised Valves ..... 11

## Electric / Manual Ball Valves

- ARAG Electric Ball Valves ..... 12
- Polmac Electric Ball Valves ..... 12
- Manual Ball Valves ..... 12-13

## Flowmeters

- Orion Electromagnetic ..... 14
- Polmac Electromagnetic ..... 14
- High Flow ..... 15
- Rapid Check ..... 16
- Manual Section Valves ..... 10
- General Purpose ..... 16
- Rapid Check Accessories ..... 17

## Nozzles

- Flat Fan Nozzles ..... 18
- Air Injected Nozzles ..... 19
- Twin Fan Nozzles ..... 19-20
- Special Nozzles ..... 20-21
- Nozzle Filters ..... 21
- Nozzle Caps ..... 22

## Nozzle Bodies

- Nozzle Bodies ..... 23-24
- Orchard / Vineyard Nozzle Bodies ..... 24

## Spraying Accessories

- Foam Marker ..... 25
- Hand Spray Guns ..... 25-26
- Hose Reel ..... 26
- Spray Hose ..... 26
- 63mm Pressure Gauges ..... 27
- 100mm Pressure Gauges ..... 27

## Filters

- Filling Filters ..... 28
- 319 Series Suction Filters ..... 28
- 317 Series Suction Filters ..... 29
- 316 Series Suction Filters ..... 29
- 314 Series Suction Filters ..... 30
- Pressure Filters ..... 31
- Line Filters ..... 31
- Mini Suction Filters ..... 32

## Fittings

- Hosetail Fittings ..... 33-35
- Threaded Fittings ..... 36-38
- General Fittings ..... 39-40
- Gaskets ..... 40-41
- Cam Lock Couplings ..... 41
- Agitators ..... 41-42
- Tank Fittings ..... 42-44
- Special Fittings ..... 44

## Chemical Mixers

- Chemical Mixers ..... 45

## Appendix 1

- Spray Nozzle Chart ..... 46-47

## Conditions of Sale

- Conditions of Sale ..... 48



## Semi-Hydraulic Boom Sprayer Pumps



### D82 Imovilli 2 Diaphragm Spray Pump

Max RPM: 550    Max Capacity: 79 L/min    Max Pressure: 20 Bar

Description	Order Code
-------------	------------

D82 Spray Pump with 1 3/8" spline .....	I3048.001
---	-----------

D82 Spray Pump with tapered shaft.....	I3048.002
--	-----------

*Order as required*

Male adapter 1 3/8" PTO 6 spline.....	Z0049
---------------------------------------	-------

Female 1 3/8" 6 spline PTO Mounting Kit.....	Z0412
--	-------

PTO protection cover.....	Z0776
---------------------------	-------

Hyd. drive pump adapt. suit 25mm Danfos OMP .....	Z0793
---	-------

Honda motor drive generator 3/4 shaft.....	Z0856
--	-------



Max RPM: 550    Max Capacity: 120 L/min    Max Pressure: 20 Bar

Description	Order Code
-------------	------------

D123 Spray Pump with 1 3/8" spline .....	I3050.001
--	-----------

*Order as required*

PTO protection cover.....	Z0839
---------------------------	-------

Hyd. drive pump adapt. suit 25mm Danfos OMP .....	Z0793
---	-------



### D133 Imovilli 3 Diaphragm Spray Pump

Max RPM: 550    Max Capacity: 130 L/min    Max Pressure: 20 Bar

Description	Order Code
-------------	------------

D133 Spray Pump with 1 3/8" spline .....	I3051.002
--	-----------

*Order as required*

PTO protection cover.....	Z0795
---------------------------	-------

PTO protection cover - unused through shaft.....	Z0777
--	-------

Hyd. drive pump adapt. suit 25mm Danfos OMP .....	Z0829
---	-------



Max RPM: 550    Max Capacity: 209 L/min    Max Pressure: 20 Bar

Description	Order Code
-------------	------------

D203 Spray Pump with 1 3/8" spline .....	I3045.001
--	-----------

*Order as required*

PTO protection cover.....	Z0795
---------------------------	-------

PTO protection cover - unused through shaft.....	Z0777
--	-------

Hyd. drive pump adapt. suit 25mm Danfos OMP .....	Z0789
---	-------



### D406 Imovilli 6 Diaphragm Spray Pump

Max RPM: 550    Max Capacity: 400 L/min    Max Pressure: 20 Bar

Description	Order Code
-------------	------------

D406 Spray Pump with 1 3/8" spline .....	I3047.001
--	-----------

*Order as required*

PTO protection cover.....	Z0774
---------------------------	-------

PTO protection cover - unused through shaft.....	Z0777
--	-------

Hyd. drive pump adapt. suit 25mm Danfos OMP .....	Z0789
---	-------





2 Diaphragm semi-hydraulic pump.  
Supplied with tapered shaft.

**Max RPM: 700    Max Capacity: 26 L/min    Max Pressure: 30 Bar**

Description

Order Code

M25 Pump ..... [I3037.002](#)

*Order as required*

C11 pump mounted controller (as shown)..... [I2605.020](#)

Remote mount kit for controller ..... [Z0730](#)

Male adaptor 1 3/8" PTO 6 spline..... [Z0046](#)

Female 1 3/8" 6 spline PTO mounting kit ..... [Z0409](#)

Pump adaptor for hydraulic drive 25mm shaft..... [Z0791](#)

PTO protection cover..... [Z0776](#)

Honda motor drive gearbox 5/8' shaft ..... [Z0816](#)

**NEW!**



## M25 12V DC Diaphragm Pump

2 Diaphragm semi-hydraulic pump.

**Max RPM: 700    Max Capacity: 20 L/min    Max Pressure: 12 Bar**

Description

Order Code

M25 Pump C/W 12V DC motor ..... [I5037.211](#)

*Order as required*

C11 pump mounted controller (as shown)..... [I2605.020](#)

Remote mount kit for controller ..... [Z0730](#)



2 Diaphragm semi-hydraulic pump.

Supplied with 1 3/8" male spline thru shaft.

**Max RPM: 700    Max Capacity: 23 L/min    Max Pressure: 25 Bar**

Description

Order Code

M25 Pump C/W 240V single phase motor ..... [I5037.204](#)

*Order as required*

C11 pump mounted controller (as shown)..... [I2605.020](#)

Remote mount kit for controller ..... [Z0730](#)



## M35 High Pressure Diaphragm Pump

3 Diaphragm semi-hydraulic pump.

Supplied with tapered shaft.

**Max RPM: 700    Max Capacity: 39 L/min    Max Pressure: 40 Bar**

Description

Order Code

M35 Pump ..... [I3039.002](#)

*Order as required*

C11 pump mounted controller (as shown)..... [I2605.020](#)

Remote mount kit for controller ..... [Z0730](#)

Male adaptor 1 3/8" PTO 6 spline..... [Z0046](#)

Female 1 3/8" 6 spline PTO mounting kit ..... [Z0409](#)

Pump adaptor for hydraulic drive 25mm shaft..... [Z0791](#)

PTO protection cover..... [Z0776](#)

Honda motor drive gearbox 3/4" shaft ..... [Z0301](#)

# Pumps & Pump Sets



3 Diaphragm semi-hydraulic pump. Supplied with tapered shaft.  
**Max RPM: 550    Max Capacity: 58 L/min    Max Pressure: 40 Bar**

Description	Order Code
-------------	------------

M60 Pump .....	I3040.002
----------------	-----------

*Order as required*

C6 pump mounted controller (as shown).....	I2605.013
Remote mount kit for controller .....	Z0844
Male adaptor 1 3/8" PTO 6 spline.....	Z0046
Female 1 3/8" 6 spline PTO mounting kit .....	Z0409
Pump adaptor for hydraulic drive 25mm shaft.....	Z0791
PTO protection cover.....	Z0776
Honda motor drive gearbox 3/4" shaft.....	Z0837



## M73 High Pressure Diaphragm Pump

3 Diaphragm semi-hydraulic pump.  
 Supplied with 1 3/8" male spline thru shaft.  
**Max RPM: 550    Max Capacity: 70 L/min    Max Pressure: 50 Bar**

Description	Order Code
-------------	------------

M73 Pump .....	I3033.001
----------------	-----------

*Order as required*

CDR controller remote mount only .....	I2606.047
Cable remote control set for CDR controller: 2.5m cables .....	Z0747
PTO protection cover.....	Z0774
PTO protection cover unused thru shaft.....	Z0777



## M135 High Pressure Diaphragm Pump

5 Diaphragm semi-hydraulic pump.  
 Supplied with 1 3/8" male spline thru shaft.  
**Max RPM: 550    Max Capacity: 115 L/min    Max Pressure: 50 Bar**

Description	Order Code
-------------	------------

M135S Pump .....	I3032.001
------------------	-----------

*Order as required*

CDR controller remote mount only .....	I2606.047
Cable remote control set for CDR controller: 2.5m cables .....	Z0747
PTO protection cover.....	Z0774
PTO protection cover unused thru shaft.....	Z0777



## M155S High Pressure Diaphragm Pump

5 Diaphragm semi-hydraulic pump.  
 Supplied with 1 3/8" male spline thru shaft.  
**Max RPM: 550    Max Capacity: 142 L/min    Max Pressure: 50 Bar**

Description	Order Code
-------------	------------

M155S Pump .....	I3036.001
------------------	-----------

*Order as required*

PTO protection cover.....	Z0774
PTO protection cover unused thru shaft.....	Z0777



### PM33 High Pressure Ceramic Plunger Pump

Max RPM: 1000    Max Capacity: 34 L/min    Max Pressure: 50 Bar

Description	Order Code
-------------	------------

PM33 High pressure ceramic plunger pump .....	I3052.001
---	-----------

*Order as required*

Honda Motor Drive Gearbox 3/4" shaft (1:3 reduction) .....	Z0867
--	-------

Honda Motor Drive Gearbox 3/4" shaft (1:6 reduction) .....	Z0301
--	-------

C11 pump mounted controller (as shown) .....	I2605.021
--	-----------



### P123 Piston Pump

High pressure piston pump with ceramic plunger for spraying and liquid fertilising. Supplied with 1 3/8" male spline thru shaft.

Max RPM: 550    Max Capacity: 118 L/min    Max Pressure: 50 Bar

Description	Order Code
-------------	------------

P123 piston pump .....	I3017.001
------------------------	-----------

*Order as required - Suits all P series pumps*

PTO protection cover .....	Z0774
----------------------------	-------

PTO protection cover unused thru shaft .....	Z0777
--	-------



### P246 Piston Pump

High pressure piston pump with ceramic plunger for spraying and liquid fertilising.

Max RPM: 550    Max Capacity: 118 L/min    Max Pressure: 50 Bar

Description	Order Code
-------------	------------

P246 piston pump .....	I3019.001
------------------------	-----------

*Order as required - Suits all P series pumps*

PTO protection cover .....	Z0774
----------------------------	-------

PTO protection cover unused thru shaft .....	Z0777
--	-------

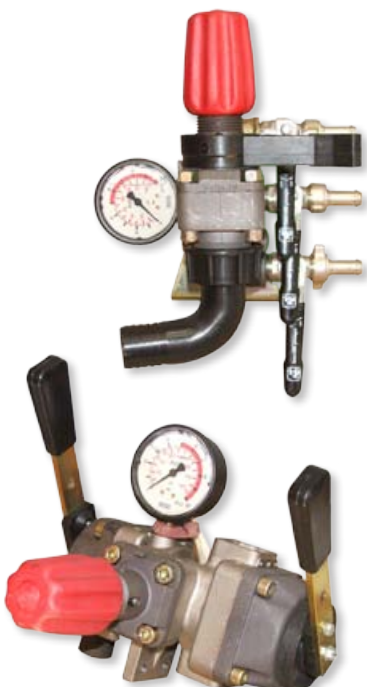

### High Pressure Controllers

Manually operated remote mount control units for high pressure pumps.

Description	Order Code
-------------	------------

CD2 remote mount controller .....	I2606.009
-----------------------------------	-----------

Max Flow: 230 L/min    Outlets: 3 Valve    Max Pressure: 50 Bar

CDR remote mount controller .....	I2606.047
-----------------------------------	-----------

Max Flow: 130 L/min    Outlets: 2 Valve    Max Pressure: 50 Bar





**2 Section electric controls with balanced manifold**

This simple 2 section upgrades from manual controls to electric in-cab control. The balanced manifold allows individual section control without the pressure spikes.

Description	Order Code
2 section electric kit - Suits Jetstream® or Computerspray®.....	495101



**2 Section electric kit - Manual pressure controlled system**

This simple 2 section electric control kit is ideal for upgrading manual valve systems to in cab electric boom section controls. Comes with manually adjustable pressure relief valve for setting spraying pressure.

Description	Order Code
2 section electric kit - pressure controlled kit .....	495121



**Main valve & electric pressure control kit**

Where electric on/off and pressure control is required from the cab, this kit provides an economical solution. Add manual section valve banks to suit if required, see over

Description	Order Code
Main valve and electric pressure controlled kit .....	495171



**Multi section boom sprayer control**

This electric control system is ideal for use where spraying speed is relatively constant and the system uses a PTO or ground driven positive displacement pump. Compensates for speed fluctuations of +/- 20%.

Description	Order Code
2 Section.....	495162
3 Section.....	495163
4 Section.....	495164
5 Section.....	495165

These complete valve sets can be used with most common spray rate controllers

### Motorised valve sets for use with broadacre boom sprayers

Includes motorised section valves, Polmac turbine flowmeter, Polmac electronic shielded sensor, flow control valve, combination pressure relief & dump.

#### Turbine flowmeter systems

Description

Order Code

#### Medium flow systems up to 100l/min bypass 3/4" tail

2 section .....	494552
3 section .....	494553
4 section .....	494554
5 section .....	494555
6 section .....	494556
7 section .....	494557



#### High flow systems with manual PRV up to 150l/min bypass 3/4" tail

2 section .....	494462
3 section .....	494463
4 section .....	494464
5 section .....	494465
6 section .....	494466
7 section .....	494467



#### High flow systems with dump up to 150l/min bypass 3/4" tail

2 section .....	494562
3 section .....	494563
4 section .....	494564
5 section .....	494565
6 section .....	494566
7 section .....	494567

When ordering, please specify 2 Wire or 3 Wire Valves & specify section valve tail sizes, eg. 1/2", 3/4", 1".

All electric control



# Valves & Valve Sets

## Valve Sets - Electromagnetic Flowmeter Systems

### Low pressure sprayer valve sets <20 bar

Includes motorised section valves, Arag Electromagnetic flowmeter, flow control valve, combination manual pressure relief & dump.



Description	Order Code
-------------	------------

#### Low flow systems up to 60 l/min bypass 1/2" tail

2 section .....	494702
3 section .....	494703
4 section .....	494704
5 section .....	494705
6 section .....	494706
7 section .....	494707

#### Medium flow systems up to 100l/min bypass 3/4" tail

2 section .....	494602
3 section .....	494603
4 section .....	494604
5 section .....	494605
6 section .....	494606
7 section .....	494607

#### High flow systems up to 150l/min bypass 1" tail

2 section .....	494612
3 section .....	494613
4 section .....	494614
5 section .....	494615
6 section .....	494616
7 section .....	494617

#### Very high flow systems up to 240l/min bypass 1 1/4" tail

2 section .....	494622
3 section .....	494623
4 section .....	494624
5 section .....	494625
6 section .....	494626
7 section .....	494627

When ordering, please specify 2 Wire or 3 Wire Valves & specify section valve tail sizes, eg. 1/2", 3/4", 1".

### High pressure vineyard & orchard sprayer valve sets +40 bar

High pressure valves, electromagnetic flowmeter and dump valve ensures reliability and maximum protection for your pump.



Description	Order Code
-------------	------------

#### Low flow systems up to 60 l/min bypass 1/2" tail

2 section .....	494752
3 section .....	494753
4 section .....	494754
5 section .....	494755

#### Medium flow systems up to 100l/min bypass 3/4" tail

2 section .....	494762
3 section .....	494763
4 section .....	494764
5 section .....	494765

#### High flow systems up to 150l/min bypass 1" tail

2 section .....	494772
3 section .....	494773
4 section .....	494774
5 section .....	494775



Main Control Units

Control unit with separate drain outlets. Includes a 3 way main shunt valve (.3sec) and a proportional control valve (7 sec). 12 Bar pressure rating with a 550l/min maximum flow.

Description	Order Code
Main Control Unit.....	4533A005



Main Control Units

2-way drain valve (switching time 0.3sec) Pressure rating to 12 Bar. Requires 12Vdc power and has a 480l/min flow capability.

Description	Order Code
Main Control Unit..... (fittings not included)	4532A000



Electric Proportional Valve (463 Series)

Fibreglass reinforced nylon body, Delrin and stainless steel internal parts, and internal resettable fuse. 40 bar pressure rating. With 7 or 14 second on/off.

Description	Order Code
14 Second Proportional Valve (Yellow).....	463024
7 Second Proportional Valve (Grey).....	463024-6S



Electric Boom Section Valve (463 Series)

Fibreglass reinforced nylon body, Delrin and stainless steel internal parts, and internal resettable fuse. 20 bar pressure rating. 2 or 3 wire configuration.

Description	Order Code
2 Wire Valve .....	463001S
3 Wire Valve .....	463001ST

When ordering, please specify hosetail size



Solenoid Valve

Viton diaphragm solenoid valve 40l/min 0.3 amp current draw 3/4" M inlet and outlet. **Pressure Rating 8 Bar.**

Description	Order Code
BSC solenoid valve viton seals 12Vdc .....	A198

# Valves & Valve Sets

## Flow Control Valve



### Flow Control Valve

Flow control valve. Used to adjust pressure with electric or spray rate controller systems. Use for Boom, Orchard or Vineyard sprayers. Suitable for updating KZ valve on Mk5.

Description	Order Code
Low flow systems up to 60l/min bypass .....	494001
Medium flow systems up to 100l/min bypass .....	494002
High flow systems up to 150l/min bypass.....	494003
Very high flow up to 240l/min bypass .....	494004

All Electric Control      Please specify valve speed: 7 or 14 seconds

## Manual Section Valves



### Manual section valve bank options

Manual boom section control which can be worked in conjunction with the main valve and pressure control kit.

Description	Order Code
Single Replacement Valve only .....	463051
2 Section valve bank complete.....	495142
3 Section valve bank complete.....	495143
4 Section valve bank complete.....	495144
5 Section valve bank complete.....	495145

When ordering, please specify hosetail size.

## Pressure Relief Valves



### Pressure Relief Valves

Spring loaded maximum pressure relief valves. Used as safety valves, they guarantee a constant pressure whenever it is not necessary to continuously regulate the working pressure.

Also Available New Piston Controlled Pressure Relief Valve.

Description	Order Code
1" PRV Inlet, 1 1/4" Outlet 15 Bar 200L/min .....	P00200016
1 1/4" PRV Inlet, 1 1/4" Outlet 20 Bar 200L/min .....	P00200102
1 1/2" PRV Inlet, 2" Outlet 20 Bar 400L/min .....	P00200022
1 1/2" PRV Inlet, 2" Outlet 20 Bar 400L/min .....	P00200072

### Pressure Relief Valves

ARAG Pressure Relief Valve



Description	Order Code
3/4" Female threads 10 Bar 200L/min .....	465531
3/4" Female threads 20 Bar 200L/min .....	465532
3/4" Female threads 30 Bar 200L/min .....	465533
3/4" Female threads 40 Bar 200L/min .....	465534
3/4" Female threads 50 Bar 200L/min .....	465535
1" Female threads 10 Bar 200L/min .....	465541
1" Female threads 20 Bar 200L/min .....	465542





**Please specify: 2 or 3 wire valves**  
1/2", 3/4" or 1" Boom outlets



**Please specify: 2 or 3 wire valves**  
3/4" or 1" Boom outlets

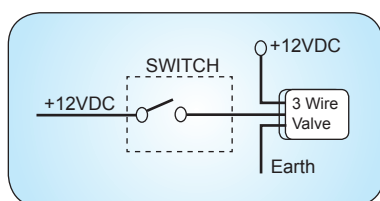

**Please specify: 2 or 3 wire valves**

### Boom section valves to replace solenoid valves - 2 or 3 wire

High quality, full flow, fast acting boom sprayer motorised valve sets to replace solenoid valves. Supplied with mounting brackets, 1" Male BSP inlet and pressure gauge outlet. Specify 1/2" or 3/4" boom outlets. Up to 44l/min per section. 0.6 sec open/close time. 0.5 amp current draw to open or close. 20 Bar pressure rating.

Description	Order Code
Valve bank 1 section.....	<a href="#">494201</a>
Valve bank 2 section.....	<a href="#">494202</a>
Valve bank 3 section.....	<a href="#">494203</a>
Valve bank 4 section.....	<a href="#">494204</a>
Valve bank 5 section.....	<a href="#">494205</a>
Valve bank 6 section.....	<a href="#">494206</a>

### Boom section valves to replace solenoid valves

High quality, high flow, fast acting boom sprayer motorised valve sets to replace solenoid valves. Supplied with mounting brackets, 1" Male BSP inlet and pressure gauge outlet. Specify 3/4" or 1" boom outlets. Up to 120 l/min per section. 0.6 sec open/close time. 0.5 amp current draw to open or close. 20 Bar pressure rating.

Description	Order Code
Valve bank 1 section.....	<a href="#">494211</a>
Valve bank 2 section.....	<a href="#">494212</a>
Valve bank 3 section.....	<a href="#">494213</a>
Valve bank 4 section.....	<a href="#">494214</a>
Valve bank 5 section.....	<a href="#">494215</a>
Valve bank 6 section.....	<a href="#">494216</a>

### High Pressure Orchard & Vineyard section valves

High quality, high pressure reliable sprayer motorised valve sets. Supplied with mounting brackets, 1" Male BSP brass inlet and pressure gauge outlet. Outlet 1/2" BSP Male. Up to 40 Bar (580psi). 0.5 amp current draw to open and close.

Description	Order Code
Valve bank 2 section.....	<a href="#">494222</a>
Valve bank 3 section.....	<a href="#">494223</a>
Valve bank 4 section.....	<a href="#">494224</a>

# Electric / Manual Ball Valves

## ARAG Electric Ball Valves

12V DC with stainless steel ball and rotation pin. The ball seal is made of Teflon and the inside O-ring is made of Viton



### 2 way electric ball valve

Description	3 Wire	2 Wire
2 way valve 1" BSP F 10 Bar.....	<a href="#">453704A44T</a>	<a href="#">453704A44</a>
2 way valve 1 1/4" BSP F 10 Bar.....	<a href="#">453704A55T</a>	<a href="#">453704A55</a>
2 way valve 1 1/2" BSP M 10 Bar.....	<a href="#">453705E66T</a>	<a href="#">453705E66</a>
2 way valve 2" BSP M 10 Bar.....	<a href="#">453706E77T</a>	<a href="#">453706E77</a>

### 3 way electric ball valve with side entry

Description	3 Wire	2 Wire
3 way valve 1" BSP F/M .....	<a href="#">453714A44T</a>	<a href="#">453714A44</a>
3 way valve 1 1/2" BSP M .....	<a href="#">453715E66T</a>	<a href="#">453715E66</a>
3 way valve 2" BSP M .....	<a href="#">453716E77T</a>	<a href="#">453716E77</a>

### 3 way electric ball valve with bottom entry

Description	3 Wire	2 Wire
3 way valve 2" BSP F .....	<a href="#">453726A77T</a>	<a href="#">453726A77</a>

## Polmac Electric Ball Valves



### Polmac ball valves

2" 6-way Ball Valve, Electric motor drive.

The motor drive kit makes it possible to select the ball valve outlets remotely. Kit includes a channel sensor an electronic control box for selecting the ball valve's outlets by means of a bi-directional rotation. The display shows which valve outlet has been activated during operation.

Description	Order Code
2" 6-way electric ball valve kit.....	<a href="#">PVTDC070M-KIT</a>

## Polmac Manual Ball Valve



### Polmac ball valves

Polmac ball valves: ball valves in aluminium body, O-rings made of viton, gaskets made of teflon PTFE, Nylon flanges.

Description	Order Code
Valve Ports 1 1/4"	3 ..... <a href="#">PVTDC1700</a> 5 ..... <a href="#">PVTDC1300</a> 6 ..... <a href="#">PVTDC3200</a>
Valve Ports 1 1/2"	3 ..... <a href="#">PVTDC2800</a> 5 ..... <a href="#">PVTDC3000</a> 6 ..... <a href="#">PVTDC3100</a>
Valve Ports 2"	3 ..... <a href="#">PVTDC0100</a> 5 ..... <a href="#">PVTDC0600</a> 6 ..... <a href="#">PVTDC0700</a>



### Continuous flow (high pressure)

Fibreglass reinforced polypropylene body. Standard EDPM gasket (viton available).

Description	Order Code
1/2" F BSP .....	4542232H
3/4" F BSP .....	4542233H
1" F BSP .....	4542234H
1 1/4" F BSP .....	4542235H
1 1/2" F BSP .....	4542236H
2" F BSP .....	4542237H

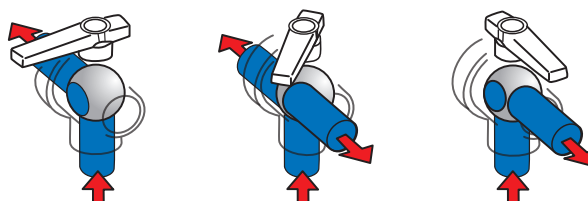

### 2 way sprayer line valve with replaceable seals

Fibreglass reinforced polypropylene body. Standard EDPM gasket (viton available).

Description	Order Code
1/2" F BSP .....	4542132
3/4" F BSP .....	4542133
1" F BSP .....	4542134
1 1/4" F BSP .....	4542135
1 1/2" F BSP .....	4542136
2" F BSP .....	4542137



### 3 Way Valves

Fibreglass reinforced polypropylene body. Standard EDPM gasket (viton available). Standard - with OFF position

Description	Order Code
1/2" F BSP .....	4542232
3/4" F BSP .....	4542233
1" F BSP .....	4542234
1 1/4" F BSP .....	4542235
1 1/2" F BSP .....	4542236
2" F BSP .....	4542237

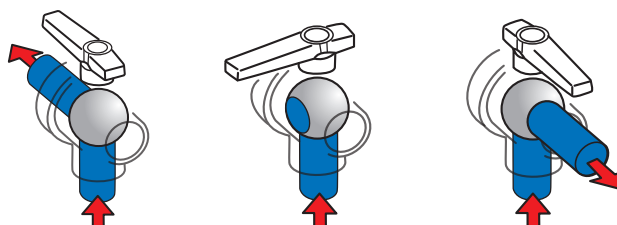



# Flowmeters

## Orion Electromagnetic Flowmeters

No  
Moving Parts



### Electromagnetic Flowmeter

Orion Electromagnetic Flowmeters with no moving parts. Low maintenance, high precision (typically .5%). Pressures up to 40 Bar. No variation between different density and viscosity fluids.

Description	Order Code
Orion 1-20 L/min 3/4" Male BSP flanges.....	<a href="#">4621AA13333</a>
Orion 2.5-50 L/min 3/4" Male BSP flanges.....	<a href="#">4621AA23333</a>
Orion 5-100 L/min 1" Male BSP flanges.....	<a href="#">4621AA33434</a>
Orion 10-200 L/min 1" Male BSP flanges.....	<a href="#">4621AA43434</a>
Orion 20-400 L/min 1 1/2" Male BSP flanges 20 Bar ...	<a href="#">4621AA51616</a>
Orion 30-600 L/min 2" Male BSP flanges 20 Bar .....	<a href="#">4621AA61717</a>
Orion .5-101 L/min Arag 463 series flanges .....	<a href="#">4621AA00000</a>
Orion 1-20 L/min Arag 463 series flanges .....	<a href="#">4621AA10000</a>
Orion 2.5-50 L/min Arag 463 series flanges .....	<a href="#">4621AA20000</a>
Orion 5-100 L/min Arag 463 series flanges .....	<a href="#">4621AA30000</a>
Orion 10-200 L/min Arag 463 series flanges .....	<a href="#">4621AA40000</a>
Orion 10-200 L/min Arag 473 series flanges 20 Bar ....	<a href="#">4622AA40000</a>
Orion 10-400 L/min Arag 473 series flanges 20 Bar ....	<a href="#">4622AA50000</a>

### Electromagnetic Flowmeter with Display

1 1/2" or 2" Male BSP. Displays flowrate (L/min), total flow. Powered by external 12V source.

Description	Order Code
Orion 1 1/2" visual flow .....	<a href="#">4622BA51616</a>
Orion 2" visual flow .....	<a href="#">4622BA61716</a>

## Polmac Electromagnetic Flowmeters



### Polmac Electromagnetic

Description	Order Code
Polmac 3-30L/min 1/2" flanges 40 Bar .....	<a href="#">P00377051</a>
Polmac 10-200L/min 1" flanges 40 Bar .....	<a href="#">P00377053</a>
Polmac 20-400L/min 1 1/2" flanges 40 Bar .....	<a href="#">P00377055</a>
Polmac 45-900L/min 2" flanges 30 Bar .....	<a href="#">P00377060</a>

Note: Arag and Braglia flanges available to suit 10 - 200L/min flowmeters



### Polmac Pro-Flow 1

Flowmeter with programmable automatic stop. Allows programming the quantities of liquid transferred: when the set value is reached, the passage opened manually with a lever, closes automatically, warning the operator with a sound signal. The unit has a maximum pressure rating of 20 Bar and comes fitted with 2" male BSP inlet and outlet.

Description	Order Code
Pro-Flow 1, 75 - 750l/min .....	<a href="#">P003790G2</a>



### Turbine filling flowmeter

Display reads batch flow and flow rate. Ceramic bearings. Accurately reads from 35L/min up to 3000L/min. 9V battery supplied. Auto off battery.

Description	Order Code
1" Filling flowmeter inc. 9V Pony-Flow 20-200L/min .....	<a href="#">P00373229</a>
1 1/2" Filling flowmeter 35-350L/min .....	<a href="#">P00373239</a>
2" Filling flowmeter 75-750L/min .....	<a href="#">P00373247</a>
3" Filling flowmeter 150-1500L/min .....	<a href="#">P00373267</a>
4" Filling flowmeter 300-3000L/min .....	<a href="#">P00373287</a>



### 2" Turbine filling flowmeter

2" Standard Flowmeter with ceramic bearings. Rated to 20 bar pressure with flow rates from 75 - 750L/min. One piece construction with Banjo flanges.

Description	Order Code
2" Flowmeter .....	<a href="#">PBJ370247</a>



### Pony Flow 4 Display

Display reads batch flow and flow rate. 9V battery supplied. Auto off battery. To suit Rapid check and standard flowmeters.

Description	Order Code
Pony Flow 4 Display - suits Standard flowmeters .....	<a href="#">P00370001</a>
Pony Flow 4 Display - suits Rapid Check flowmeters .....	<a href="#">P00370004</a>

Rapid Check Flowmeters



1 1/2" Low Pressure Rapid Check Flowmeter

Allows easy removal of turbine for cleaning. Suitable for pressures up to 20 Bar. Sapphire bearings with a flow rate from 35 - 350L/min.

Description	Order Code
1 1/2" 20 bar Flowmeter .....	<a href="#">P00375246</a>



2" Low Pressure High Flow Rapid Check Flowmeter

Allows easy removal of turbine for cleaning. Suitable for pressures up to 20 Bar. Sapphire bearings with a flow rate from 75 - 750L/min.

Description	Order Code
2" 20 bar Flowmeter .....	<a href="#">PBJ376008</a>



High Pressure Rapid Check Flowmeter

Allows easy removal of turbine for cleaning. Supplied with high quality sapphire bearings for long life. Suitable for pressures up to 50 Bar (700 psi). Supplied with sensor. Some spray computers may require pulse divider. Please check with Topcon staff.

Description	Order Code
Flowmeter 2-40L/min 1 1/4" Male BSP flanges .....	<a href="#">4623811</a>
Flowmeter 10-200L/min 1 1/4" Male BSP flanges .....	<a href="#">4623812</a>
Flowmeter 2-40L/min 1" Male BSP flanges .....	<a href="#">4623821</a>
Flowmeter 10-200L/min 1" Male BSP flanges .....	<a href="#">4623822</a>
Flowmeter 2-40L/min 3/4" Male BSP flanges .....	<a href="#">4623831</a>
Flowmeter 10-200L/min 3/4" Male BSP flanges .....	<a href="#">4623832</a>
Flowmeter 2-40L/min Arag flanges .....	<a href="#">4623861</a>
Flowmeter 10-200L/min Arag flanges .....	<a href="#">4623862</a>
Flowmeter 2-40L/min Braglia flanges .....	<a href="#">4623871</a>
Flowmeter 10-200L/min Braglia flanges .....	<a href="#">4623872</a>

Sensor Included  
(P413003AL)





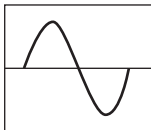

### Rapid Check Sensors

To suit Rapid Check Flowmeters

Description	Order Code
-------------	------------

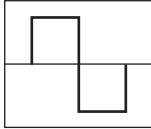

Green - Sinusoidal Wave.....	<a href="#">P41308899</a>
------------------------------	---------------------------

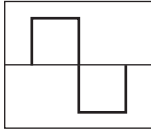

Yellow - Square Wave .....	<a href="#">P41300399</a>
----------------------------	---------------------------

Black (Aluminium Shielded) - Square Wave.....	<a href="#">P413003AL</a>
---	---------------------------



10-200l/min



2-20l/min

### Rapid Check Impellor Insert

To suit Rapid Check Flowmeters

Description	Order Code
-------------	------------

Low flow insert	2 - 20 l/min .....	<a href="#">P41316499</a>
-----------------	--------------------	---------------------------

High flow insert	10 - 200 l/min .....	<a href="#">P41316399</a>
------------------	----------------------	---------------------------

### Pulse Divider

May be required when using a rapid check flowmeter. Please check with Topcon staff.



Description	Order Code
-------------	------------

Pulse Divider .....	<a href="#">A629</a>
---------------------	----------------------



## Flat Fan Nozzles



Nozzle Sizes	
Size	Colour
015	Green
020	Yellow
025	Lilac
030	Blue
040	Red



### STD: Standard Nozzles

Suitable for the application of herbicide, fungicide & insecticide. Excellent for use over a range of pressures from 2 to 4 bar.

Flat fan pattern 110° (80° also available)

Adaptable to every brand of sprayer

Description

Order Code

Sprays Int. Nylon Nozzle ..... [STD-110-XXX-N](#)

Note: XXX refers to size. ie.. 015, 020 etc (see chart)

Nozzle Sizes	
Size	Colour
015	Green
020	Yellow
025	Lilac
030	Blue
040	Red



### XTR: Universal Nozzles

A universal nozzle providing a 110° full spray angle across pressures from 1 to 4 bar. Ideal for lower pressures with an even and full coverage over the full pressure range.

Flat fan pattern 110° (80° also available)

Adaptable to every brand of sprayer

Description

Order Code

Sprays Int. Nylon Nozzle ..... [XTR-110-XXX-N](#)

Albuz Ceramic Nozzle ..... [XTR-110-XXX-C](#)

Note: XXX refers to size. ie.. 015, 020 etc (see chart)

Nozzle Sizes	
Size	Colour
010	Orange
015	Green
020	Yellow
030	Blue
040	Red



### Low Drift Flat Fan Nozzles

Suitable for the application of herbicide, fungicide & insecticide. Controls drift by reducing the number of small droplets (<100µ) by 50%. Use at pressures from 2 to 4 bar.

Flat fan pattern 110°

Adaptable to every brand of sprayer

Description

Order Code

Sprays Int. Nylon Nozzle ..... [LD-110-XXX-N](#)

Ceramic Nozzle ..... [LD-110-XXX-C](#)

Note: XXX refers to size. ie.. 015, 020 etc (see chart)

Nozzle Sizes	
Size	Colour
015	Green
020	Yellow
030	Blue
040	Red



### Evenfan Nozzles

Particularly suitable for single nozzle applications with knapsack sprayers producing an even band of spray where reduced dosing at the edge is avoided. Use at pressures from 2 to 4 bar.

Flat fan pattern 80°

Adaptable to every brand of sprayer

Description

Order Code

Sprays Int. Nylon Nozzle ..... [EF-80-XXX-N](#)

Note: XXX refers to size. ie.. 015, 020 etc (see chart)

**Air Injected Nozzles****Nozzle Sizes**

Size	Colour
010	Orange
015	Green
020	Yellow
025	Lilac
030	Blue
040	Red

**Standard Fan Air: Air Injected**

Suitable for all types of treatment including liquid fertilisers. Air injected spray nozzle (Venturi System): sprays large drops charged with air bubbles. Use at a wide range of pressures from 2 to 7 bar.

Flat fan pattern 110°

Adaptable to all booms and most nozzle bodies

**Description****Order Code**

Sprays Int. Nylon Nozzle ..... [AI-110-XXX-N](#)  
 Albuz Ceramic Nozzle ..... [AI-110-XXX-C](#)

Note: XXX refers to size. ie.. 015, 020 etc (see chart)

**Nozzle Sizes**

Size	Colour
020	Yellow
030	Blue
040	Red
050	Brown

**Twin Fan Air: Air Injected**

This nozzle inducts air to produce larger droplets that do not drift as easily. These nozzles use a 110° standard flat fan which sprays 30° forwards and 30° backwards providing a double angle of attack for improved penetration.

Flat fan pattern 110°

Adaptable to all booms and most nozzle bodies

**Description****Order Code**

Sprays Int. Nylon Nozzle ..... [AITJ-110-XXX-N](#)

Note: XXX refers to size. ie.. 015, 020 etc (see chart)

**Twin Fan Nozzles****Nozzle Sizes**

Size	Colour
020	Yellow
030	Blue
040	Red
050	Brown

**Twin Fan Standard**

The Twin Fan Standard design comprises of a 110° standard flat fan which sprays 30° forwards and 30° backwards providing a double angle of attack for improved penetration.

Flat fan pattern 110°

Adaptable to all booms and most nozzle bodies

**Description****Order Code**

Sprays Int. Nylon Nozzle ..... [STDTJ-110-XXX-N](#)

Note: XXX refers to size. ie.. 015, 020 etc (see chart)



## Twin Fan Nozzles



Nozzle Sizes	
Size	Colour
020	Yellow
030	Blue
040	Red
050	Brown



### Twin Fan Low Drift

The Twin Fan Low Drift nozzle gives the benefits of the Twin Fan nozzle while minimising the spray drift, giving greater accuracy.

Flat fan pattern 110°

Adaptable to all booms and most nozzle bodies

Description

Order Code

Sprays Int. Nylon Nozzle ..... [LDTJ-110-XXX-N](#)

Note: XXX refers to size. ie.. 015, 020 etc (see chart)

## Special Nozzles

Nozzle Sizes	
Size	Colour
1.0	Yellow
1.5	Blue
2.0	Red
2.5	Brown
3.0	Grey
4.0	White
5.0	Lt Blue
7.5	Green
10.0	Black



### Deflector

Deflector nozzles have a wide 140° spray angle, which means the nozzles can be placed up to 1m apart reducing the number of nozzles required. Pressure range from 1 to 3 bar.

Adaptable to most nozzle bodies

Description

Order Code

Sprays Int. Nylon Nozzle ..... [DEF-140-XXX-N](#)

Note: XXX refers to size. ie.. 015, 020 etc (see chart)

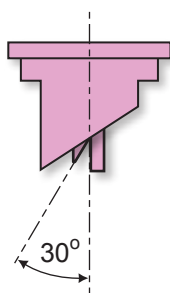

### Tilt 30

Tilt 30 nozzles have a 110° spray pattern 30° to the vertical. Specially designed for spraying slender vertical grasses.

Adaptable to most nozzle bodies

Description

Order Code

Sprays Int. Nylon Nozzle ..... [TILT-110-030-N](#)

Bar	L/min					
	3	4	5	7	10	15
White	0.21	0.24	0.27	0.32	0.38	0.46
Lilac	0.29	0.33	0.35	0.41	0.49	0.61
Brown	0.39	0.44	0.48	0.55	0.67	0.85
Yellow	0.55	0.64	0.71	0.80	0.95	1.19
Orange	0.81	0.94	1.02	1.16	1.40	1.73
Red	1.15	1.27	1.36	1.57	1.89	2.36
Grey	1.18	1.35	1.50	1.76	2.08	2.51
Green	1.46	1.64	1.77	2.07	2.45	3.07
Black	1.57	1.80	2.00	2.35	2.78	3.36
Blue	2.02	2.21	2.40	2.80	3.37	4.05



### Hollowcone Ceramic

These nozzles use a ceramic insert giving better wear characteristics. Pressures from 3 to 5 bar gives optimum spray performance, however up to 15 bar can be used. Mainly designed for horticultural applications with an 80° spray angle.

Adaptable to most nozzle bodies

Description

Order Code

Sprays Int. Ceramic Nozzle ..... [HC-80-XXX-C](#)

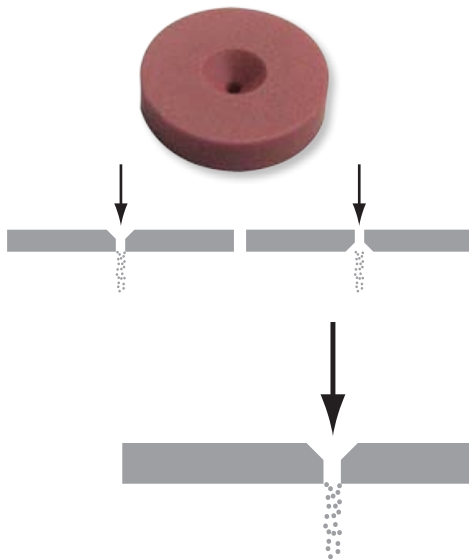

### AMT Ceramic Metering Disc Nozzle

Ceramic metering disc nozzle common to spray bodies used in orchards and viticulture.

Description

Order Code

Ceramic Nozzle ..... [AMT-XXX-C](#)

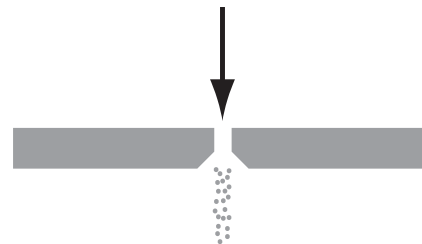

Litres/min									
Size:	AMT	AMT	AMT	AMT	AMT	AMT	AMT	AMT	AMT
Bar	007	008	010	012	015	018	020	023	040
2	0.42	0.54	0.91	1.14	1.88	2.54	3.09	3.98	12.28
3	0.51	0.66	1.10	1.39	2.27	3.12	3.77	4.91	15.06
4	0.59	0.75	1.25	1.60	2.60	3.60	4.35	5.70	17.40
5	0.65	0.83	1.38	1.78	2.89	4.03	4.86	6.40	19.46
10	0.91	1.15	1.89	2.51	3.09	5.70	6.85	9.17	27.56
15	1.10	1.39	2.27	3.06	4.82	6.98	8.37	11.31	33.78
20	1.27	1.59	2.59	3.52	5.51	8.06	9.65	13.13	39.03
30	1.54	1.92	3.11	4.30	6.65	9.88	11.80	16.20	47.84
50	1.96	2.43	3.91	5.52	8.44	12.76	15.20	21.12	61.83

Litres/min									
Size:	AMT	AMT	AMT	AMT	AMT	AMT	AMT	AMT	AMT
Bar	007	008	010	012	015	018	020	023	040
2	0.41	0.43	0.65	0.94	1.42	1.98	2.46	3.18	10.13
3	0.50	0.53	0.79	1.15	1.73	2.42	3.02	3.90	12.41
4	0.57	0.61	0.91	1.32	2.00	2.80	3.50	4.50	14.33
5	0.64	0.68	1.01	1.47	2.23	3.13	3.92	5.03	16.03
10	0.89	0.95	1.42	2.07	3.15	4.43	5.58	7.12	22.68
15	1.08	1.16	1.74	2.53	3.85	5.42	6.87	8.72	27.79
20	1.24	1.34	2.00	2.92	4.44	6.26	7.95	10.07	32.09
30	1.50	1.63	2.44	3.56	5.43	7.67	9.78	12.33	39.32
50	1.92	2.09	3.13	4.58	6.99	9.90	12.68	15.92	50.79



### One piece extended range ceramic nozzle moulded into the cap

Description

Order Code

Sprays Int. Ceramic Nozzle ..... [TCXI-110-XXX-C](#)

## Nozzle Filters



### Nozzle Body Filters

Description





Order Code

50 Mesh.....[424310](#)  
 100 Mesh.....[424311](#)  
 50 Mesh with non drip ball check valve.....[424210](#)  
 100 Mesh with non drip ball check valve.....[424211](#)  
 50 Mesh cup filter.....[424303](#)  
 100 Mesh cup filter.....[424304](#)

Caps

Bayonet Caps

Standard caps to fit all Sprays International nozzles, colour coded and supplied with a sealing washer.

Available for:	Order Code
 Fan	B-CAP-F-XX
 Twinfan	B-CAP-F-XX
 Deflector	B-CAP-D-XX
 Hollow Cone Ceramic	B-CAP-HC-XX

Note: XX refers to cap colour

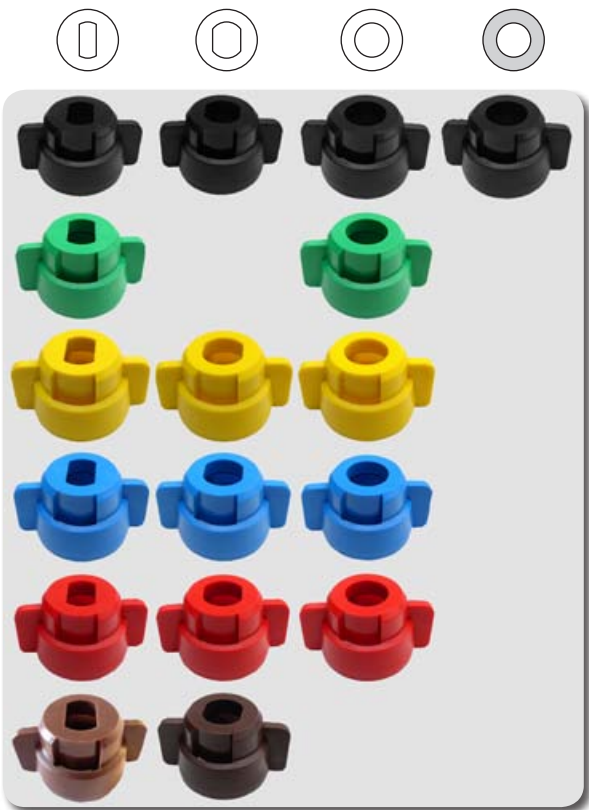

Quick Fitting Cap with Hosetail

Description	Order Code
With 10mm hosetail complete with gasket .....	105110C

Nozzle Sizes	
Code	Colour
013	Lilac
03	Red
04	Blue
05	Green
06	Yellow
08	Orange



Uni-Cap Universal Nozzle Cap

To suit almost all commercial spray nozzles, eliminating stocking different nozzle caps for different nozzle applications.

Description	Order Code
Uni-Cap Nozzle Cap .....	402990 - XX

Note: XX refers to colour (see chart)



Internal Threaded Nozzle Cap

Ideal for use with pressure gauges to test individual nozzle pressure.

Description	Order Code
Threaded Nozzle Cap .....	40291001





400 Series

Description	Order Code
Fits 19mm (OD) pipe, 3/8" BSP Cap (1/2" BSP pipe).....	<a href="#">400530-1</a>
Fits 32mm (OD) pipe, 3/8" BSP Cap (1" BSP pipe).....	<a href="#">400560-1</a>

Kit includes locking screw & O-ring



402 Series

Description	Order Code
Fits 19mm (OD) pipe (1/2" BSP pipe).....	<a href="#">402745-1</a>
Fits 25mm (OD) pipe (3/4" BSP pipe).....	<a href="#">402755-1</a>
Fits 32mm (OD) pipe (1" BSP pipe).....	<a href="#">402765-1</a>

Kit includes locking screw & O-ring



Single Nozzle Holder

Description	Order Code
1/4" Male BSP thread .....	<a href="#">402275</a>
3/8" Male BSP thread .....	<a href="#">402275</a>



Triple Nozzle Holder

With non drip check valve and universal quick fitting.

Description	Order Code
To fit 19mm OD pipe (1/2" BSP).....	<a href="#">40642W7</a>
To fit 25mm OD pipe (3/4" BSP).....	<a href="#">40642Y7</a>

Hose Fittings	Order Code
1/2" terminal hose fitting .....	<a href="#">426413</a>
1/2" through hose fitting .....	<a href="#">427413</a>
3/4" terminal hose fitting .....	<a href="#">426519</a>
3/4" through hose fitting .....	<a href="#">427519</a>

Also available with dry boom hose fittings.



Triple Nozzle Holder 1"

With non drip check valve and universal quick fitting.

Description	Order Code
To fit 32mm OD pipe (1" BSP).....	<a href="#">4064267</a>



Five Way Nozzle Holder 1"

With non drip check valve and universal quick fitting.

Description	Order Code
To fit 32mm OD pipe (1" BSP) with viton gaskets .....	<a href="#">40649J7V</a>

# Nozzle Bodies

## Nozzle Bodies



### Dry Boom Nozzle Holder

Quick fitting dry boom nozzle bodies with locking nut. Ideal for retrofitting and small booms.

**Max 10 Bar (150psi) working pressure, 13mm hose barbs.**

Description	Order Code
Dry boom nozzle body - double barb.....	<a href="#">B714.700.24</a>
Dry boom nozzle body - single left barb .....	<a href="#">B714.700.25</a>
Dry boom nozzle body - single right barb .....	<a href="#">B714.700.26</a>



### 413 Series Nozzle Holders

For use with boom mounting clamps. With non drip check valve.

Description	Order Code
Elbow 1/2" hosetail .....	<a href="#">413212</a>
Elbow 3/4" hosetail .....	<a href="#">413213</a>
Tee 1/2" hosetail .....	<a href="#">413222</a>
Tee 3/4" hosetail .....	<a href="#">413223</a>
Low profile elbow 1/2" hosetail .....	<a href="#">413412</a>
Low profile tee 1/2" hosetail .....	<a href="#">413422</a>



### 413 Series Mounting Clamps

Suits triple nozzle holder also.

Description	Order Code
To suit 3/4" square tube .....	<a href="#">413013</a>
To suit 1" square tube .....	<a href="#">413014</a>
To suit 1 1/4" square tube .....	<a href="#">413015</a>



### Orchard / Vineyard Nozzle Bodies

With non drip valve adjustable positioning.  
1/4" Male BSP thread.

Description	Order Code
Orchard / Vineyard nozzle body .....	<a href="#">005882</a>

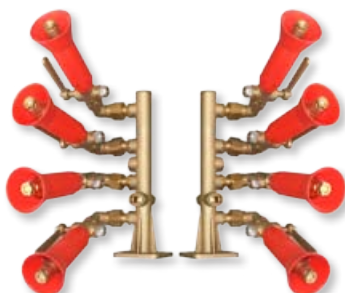

### Spray Column

Column shaped spray boom with swivel joint, with microjet cone ceramic nozzle, 1.5mm. Adjustable heads with 4 heads per side.

Description	Order Code
Spray column.....	<a href="#">004123</a>

## Foam Markers



### Foam Marker Complete Kit

Double sided foam marker with 20 litre tank and in cab controls. 12v compressor in sealed cabinet.

Description	Order Code
-------------	------------

Foam Marker (complete) .....	520004
------------------------------	--------

## Hand Spray Guns



### Galaxy Spray Pistol

Adjustable spray pattern. Up to 50 bar (700 psi). Aluminium barrel. Supplied with 1/2" hose swivel.

Description	Order Code
-------------	------------

Spray Gun .....	506400
-----------------	--------



### Heavy Duty Spray Gun

Ideal for firefighting, high pressure machinery washdown and tall tree or scrub spraying. Spray up to 25m. Front handle adjusts spray pattern. Supplied with 1/2" hose swivel.

Description	Order Code
-------------	------------

Long Range HP Spray Gun .....	002201
-------------------------------	--------



### Spray Lances

Poly or brass hand piece, brass lance with adjustable cone nozzle.

Description	Order Code
-------------	------------

Spray Lance 500mm - Poly hand piece .....	001650
Spray Lance 500mm - Brass with twin nozzle .....	001992
Optional double nozzle head 1.5mm .....	001800



### Economy Hand Gun

Delrin body hand piece, PVC barrel 3/8" threaded cap, takes flat fan or hollowcone nozzles. Maximum working pressure 25 bar.

Description	Order Code
-------------	------------

Delrin Washing Gun .....	506622
--------------------------	--------

### Optional Spray Shields

Ideal for under vine or vegetable mid row spraying.

Description	Order Code
-------------	------------

Spray gun shield, flat fan, with nozzle assembly .....	001950
Spray gun shield, cone spray, with nozzle assembly .....	P0539998



# Spraying Accessories

## Hand Spray Guns



### Turbo 400 Spray Gun

Adjustable spray pattern. Up to 50 bar (700 psi). Made from highly resistant plastic materials, stainless steel and brass. Ideal for vineyards, orchards or greenhouse spraying. C/W 1/2" swivel connection.

Description	Order Code
Turbo 400 Spray Gun .....	<a href="#">B26.901.165</a>



### Spot 300 Spray Gun

Ajustable spray pattern. Up to 20 bar (290 psi). Made from highly resistant plastic materials, stainless steel and brass. 300mm brass nozzle extension with a trigger lock and drip free shut off. Ideal for Agricultural, Horticultural, and Floricultural spraying.

Description	Order Code
Spot 300 Spray Gun .....	<a href="#">B35.901.16</a>



### Swivel Connector 1/2" BSP (male to female)

Description	Order Code
Swivel Connector .....	<a href="#">B26.1502.45</a>

## Hose Reels



### Hose Reel

Fibreglass reinforced polypropylene reel on galvanised frame. 50m capacity, brass swivel maximum working pressure 100 bar.

Description	Order Code
Hose Reel MT 50 .....	<a href="#">959000</a>

## Spray Hose



### Spraying Hose

Imported chemical resistant hose. Suitable for boom sprayers, handgun spraying and high pressure sprayers.

Description	Order Code
100m 10mm PVC Spraying hose 25 bar 10x14(d) .....	<a href="#">950220</a>
100m 10mm PVC Spraying hose 50 bar 10x17(d) .....	<a href="#">950420</a>
100m 13mm PVC Spraying hose 25 bar 13x19(d) .....	<a href="#">950230</a>
100m 13mm PVC Spraying hose 40 bar 13x21(d) .....	<a href="#">950430</a>

## 63mm Pressure Gauges

### Rear Entry Pressure Gauges



Description	Order Code
63mm 0-10 bar Pressure Gauge .....	<a href="#">909010</a>
63mm 0-25 bar Pressure Gauge .....	<a href="#">909025</a>
63mm 0-40 bar Pressure Gauge .....	<a href="#">909040</a>
63mm 0-60 bar Pressure Gauge .....	<a href="#">909060</a>
63mm 0-80 bar Pressure Gauge .....	<a href="#">909080</a>
63mm 0-100 bar Pressure Gauge .....	<a href="#">909100</a>



### 2 Stage Rear Entry Pressure Gauges

Description	Order Code
63mm 0-5-20 bar Pressure Gauge .....	<a href="#">9170525</a>
63mm 0-15-60 bar Pressure Gauge .....	<a href="#">9171560</a>
63mm 0-20-60 bar Pressure Gauge .....	<a href="#">9172060</a>

### Bottom Entry Pressure Gauges



Description	Order Code
63mm 0-6 bar Pressure Gauge .....	<a href="#">911006</a>
63mm 0-10 bar Pressure Gauge .....	<a href="#">911010</a>
63mm 0-10 bar <b>Stainless Steel</b> Pressure Gauge .....	<a href="#">911010S</a>
63mm 0-16 bar Pressure Gauge .....	<a href="#">911016</a>
63mm 0-25 bar Pressure Gauge .....	<a href="#">911025</a>
63mm 0-30 bar Pressure Gauge .....	<a href="#">911030</a>
63mm 0-40 bar Pressure Gauge .....	<a href="#">911040</a>
63mm 0-60 bar Pressure Gauge .....	<a href="#">911060</a>
63mm 0-100 bar Pressure Gauge .....	<a href="#">911100</a>



### 2 Stage Bottom Entry Pressure Gauges

Description	Order Code
63mm 0-5-20 bar Pressure Gauge .....	<a href="#">9180525</a>
63mm 0-15-60 bar Pressure Gauge .....	<a href="#">9181560</a>
63mm 0-20-60 bar Pressure Gauge .....	<a href="#">9182060</a>

## 100mm Pressure Gauges

### Bottom Entry Pressure Gauges



Description	Order Code
100mm 0-8 bar Pressure Gauge .....	<a href="#">913008</a>
100mm 0-30 bar Pressure Gauge .....	<a href="#">913030</a>
100mm 0-40 bar Pressure Gauge .....	<a href="#">913040</a>
100mm 0-60 bar Pressure Gauge .....	<a href="#">913060</a>

### 2 Stage Bottom Entry Pressure Gauges

Description	Order Code
100mm 0-5-25 bar Pressure Gauge .....	<a href="#">9190525</a>
100mm 0-5-25 bar Pressure Gauge 1/4" Entry .....	<a href="#">91910525</a>
100mm 0-15-60 bar Pressure Gauge 1/4" Entry .....	<a href="#">91911560</a>

# Filters

## Filling Filters



### High Capacity Filling Filters 2" & 3"

2" with 3/4" flush facility, 380L/min.  
3" with 1" flush facility, 800L/min.

Description	Order Code
2" 32 mesh .....	333072
2" 50 mesh .....	333073
2" 80 mesh .....	3330735
2" 100 mesh .....	333074
2" 32 mesh replacement screen .....	317002.030
2" 50 mesh replacement screen .....	317003.030
2" 80 mesh replacement screen .....	3170035.030
2" 100 mesh replacement screen .....	317004.030
3" 32 mesh .....	335092
3" 50 mesh .....	335093
3" 80 mesh .....	3350935
3" 100 mesh .....	335094
3" 50 mesh replacement screen .....	335003.030
3" 80 mesh replacement screen .....	3350035.030
3" 100 mesh replacement screen .....	335004.030

## 319 Series Suction Filters



### 3" Suction Filter

3" Suction Filter with a filtering capacity of 400 - 800L/min.  
Polypropylene body with brass fixing inserts.

Description	Order Code
3" 32 mesh .....	319092
3" 50 mesh .....	319093
3" 80 mesh .....	3190935

#### Replacement Screens to suit 319 Series Suction Filters

32 mesh replacement screen .....	335002.030
50 mesh replacement screen .....	335003.030
80 mesh replacement screen .....	3350035.030
100 mesh replacement screen .....	335004.030



## 317 Series Suction Filters

### 2" Suction Filter

2" Suction Filter with a filtering capacity of 200 - 260L/min.  
Polypropylene body with brass fixing inserts.



Description	Order Code
2" 32 mesh (42mm inlet thread length) .....	<a href="#">317172</a>
2" 50 mesh (42mm inlet thread length) .....	<a href="#">317173</a>
2" 80 mesh (42mm inlet thread length) .....	<a href="#">3171735</a>
2" 100 mesh (42mm inlet thread length) .....	<a href="#">317174</a>
2" 32 mesh (20mm inlet thread length).....	<a href="#">317072</a>
2" 50 mesh (20mm inlet thread length).....	<a href="#">317073</a>
2" 80 mesh (20mm inlet thread length).....	<a href="#">3170735</a>
2" 100 mesh (20mm inlet thread length).....	<a href="#">317074</a>

### 2" Suction Filter with Auto Shutoff Valve

2" Suction Filter with a filtering capacity of 200 - 260L/min.  
Includes auto shutoff valve for easy cleaning when the tank is full.  
Polypropylene body with brass fixing inserts.



Description	Order Code
2" 32 mesh (42mm inlet thread length).....	<a href="#">317572</a>
2" 50 mesh (42mm inlet thread length).....	<a href="#">317573</a>
2" 80 mesh (42mm inlet thread length).....	<a href="#">3175735</a>
2" 100 mesh (42mm inlet thread length).....	<a href="#">317574</a>
2" 32 mesh (20mm inlet thread length).....	<a href="#">317472</a>
2" 50 mesh (20mm inlet thread length).....	<a href="#">317473</a>
2" 80 mesh (20mm inlet thread length).....	<a href="#">3174735</a>
2" 100 mesh (20mm inlet thread length).....	<a href="#">317474</a>

#### Replacement Screens to suit all 317 Series Suction Filters

32 mesh replacement screen .....	<a href="#">317002.030</a>
50 mesh replacement screen .....	<a href="#">317003.030</a>
80 mesh replacement screen .....	<a href="#">3170035.030</a>
100 mesh replacement screen .....	<a href="#">317004.030</a>

## 316 Series Suction Filters

### 2" Suction Filter

2" Suction Filter with a filtering capacity of 160 - 220L/min.  
Polypropylene body with brass fixing inserts.



Description	Order Code
2" 220l/min 32 mesh (42mm inlet thread length).....	<a href="#">316172</a>
2" 220l/min 50 mesh (42mm inlet thread length).....	<a href="#">316173</a>
2" 220l/min 80 mesh (42mm inlet thread length).....	<a href="#">3161735</a>
2" 220l/min 32 mesh (20mm inlet thread length).....	<a href="#">316072</a>
2" 220l/min 50 mesh (20mm inlet thread length).....	<a href="#">316073</a>
2" 220l/min 80 mesh (20mm inlet thread length).....	<a href="#">3160735</a>

# Filters

## 316 Series Suction Filters



### 2" Suction Filter with Auto Shutoff Valve

2" Suction Filter with a filtering capacity of 160 - 220L/min.  
Includes auto shutoff valve for easy cleaning when the tank is full.  
Polypropylene body with brass fixing inserts.

Description	Order Code
2" 220l/min 50 mesh (42mm inlet thread length).....	<a href="#">316573</a>
2" 220l/min 80 mesh (42mm inlet thread length).....	<a href="#">3165735</a>
2" 220l/min 100 mesh (42mm inlet thread length).....	<a href="#">316574</a>
2" 220l/min 50 mesh (20mm inlet thread length).....	<a href="#">316473</a>
2" 220l/min 80 mesh (20mm inlet thread length).....	<a href="#">3164735</a>
2" 220l/min 100 mesh (20mm inlet thread length).....	<a href="#">316474</a>

#### Replacement Screens to suit all 316 Series Suction Filters

32 mesh .....	<a href="#">316002.030</a>
50 mesh .....	<a href="#">316003.030</a>
80 mesh .....	<a href="#">3160035.030</a>
100 mesh .....	<a href="#">316004.030</a>

## 314 Series Suction Filters



### 1 1/2" Suction Filter

1 1/2" Suction Filter with a filtering capacity of 100 - 160L/min.  
Polypropylene body with brass fixing inserts.

Description	Order Code
1 1/2" 160l/min 50 mesh (42mm inlet thread length).....	<a href="#">314163</a>
1 1/2" 160l/min 80 mesh (42mm inlet thread length).....	<a href="#">3141635</a>
1 1/2" 160l/min 100 mesh (42mm inlet thread length).....	<a href="#">314164</a>
1 1/2" 160l/min 50 mesh (20mm inlet thread length).....	<a href="#">314063</a>
1 1/2" 160l/min 80 mesh (20mm inlet thread length).....	<a href="#">3140635</a>
1 1/2" 160l/min 100 mesh (20mm inlet thread length).....	<a href="#">314064</a>

### 1 1/2" Suction Filter with Auto Shutoff Valve

1 1/2" Suction Filter with a filtering capacity of 100 - 160L/min.  
Includes auto shutoff valve for easy cleaning when the tank is full.  
Polypropylene body with brass fixing inserts.

Description	Order Code
1 1/2" 160l/min 50 mesh (42mm inlet thread length).....	<a href="#">314563</a>
1 1/2" 160l/min 80 mesh (42mm inlet thread length).....	<a href="#">3145635</a>
1 1/2" 160l/min 100 mesh (42mm inlet thread length).....	<a href="#">314564</a>
1 1/2" 160l/min 50 mesh (20mm inlet thread length).....	<a href="#">314463</a>
1 1/2" 160l/min 80 mesh (20mm inlet thread length).....	<a href="#">3144635</a>
1 1/2" 160l/min 100 mesh (20mm inlet thread length).....	<a href="#">314464</a>

#### Replacement Screens to suit all 314 Series Suction Filters

50 mesh .....	<a href="#">314003.030</a>
80 mesh .....	<a href="#">3140035.030</a>
100 mesh .....	<a href="#">314004.030</a>

## Pressure Filters



### High Pressure Line Filter

1/2" & 3/4" inlets and outlets, flushing valve & 80# screen.  
Suitable for orchard and vineyard sprayers.  
**Maximum pressure of 50 bar (725psi).**

Description	Order Code
80 mesh line filter .....	<a href="#">3450335</a>
Replacement Screens	Order Code
50 mesh .....	<a href="#">325003.030</a>
80 mesh .....	<a href="#">3250035.030</a>
100 mesh .....	<a href="#">325004.030</a>



### Flanged High Pressure Line Filter, series 3452

To suit an ARAG manifold valve set. Supplied with an 80# screen.  
Suitable for broadacre, orchard and vineyard sprayers.  
**Maximum pressure of 50 bar (725psi).**

Description	Order Code
80 mesh flanged line filter .....	<a href="#">345210350</a>
Replacement Screens	Order Code
50 mesh .....	<a href="#">325003.030</a>
80 mesh .....	<a href="#">3250035.030</a>
100 mesh .....	<a href="#">325004.030</a>

## 328 Series In-line Filters



### In-line Filter, 1 1/2" & 1 1/4"

200-280 L/min. With female BSP thread.

Description	1 1/2"	1 1/4"
Filter with 50 mesh .....	<a href="#">3282063</a>	<a href="#">3282053</a>
Filter with 80 mesh .....	<a href="#">32820635</a>	<a href="#">32820535</a>
Filter with 100 mesh .....	<a href="#">3282064</a>	<a href="#">3282054</a>
Replacement Screens	Order Code	
50 mesh .....	<a href="#">326003.030</a>	
80 mesh .....	<a href="#">3260035.030</a>	
100 mesh .....	<a href="#">326004.030</a>	

## 326 Series In-line Filters



### In-line Filter, 1 1/2" & 1 1/4"

200-280 L/min. With male BSP thread.

Description	1 1/2"	1 1/4"
Filter with 50 mesh .....	<a href="#">3262063</a>	<a href="#">3262053</a>
Filter with 80 mesh .....	<a href="#">32620635</a>	<a href="#">32620535</a>
Filter with 100 mesh .....	<a href="#">3262064</a>	<a href="#">3262054</a>
Replacement Screens	Order Code	
50 mesh .....	<a href="#">326003.030</a>	
80 mesh .....	<a href="#">3260035.030</a>	
100 mesh .....	<a href="#">326004.030</a>	

# Filters

## 324 Series In-line Filters



### In-line Filter 1"

14 Bar pressure capacity. With female BSP thread. 160 L/min.

Description	Order Code	Rep.Screen
1" Filter with 50 mesh .....	<a href="#">3244043</a>	<a href="#">323003.030</a>
1" Filter with 80 mesh .....	<a href="#">32440435</a>	<a href="#">3230035.030</a>
1" Filter with 100 mesh .....	<a href="#">3244044</a>	<a href="#">323004.030</a>

### In-line Filter 3/4" & 1/2"

14 Bar pressure capacity. With female BSP thread. 100 L/min.

Description	3/4"	1/2"
Filter with 50 mesh .....	<a href="#">3242033</a>	<a href="#">3242023</a>
Filter with 80 mesh .....	<a href="#">32420335</a>	<a href="#">32420235</a>
Filter with 100 mesh .....	<a href="#">3242034</a>	<a href="#">3242024</a>

## 322 Series In-line Filters



### In-line Filter 1"

14 Bar pressure capacity. With male BSP thread. 160 L/min.

Description	Order Code	Rep.Screen
1" Filter with 50 mesh .....	<a href="#">3224043</a>	<a href="#">323003.030</a>
1" Filter with 80 mesh .....	<a href="#">32240435</a>	<a href="#">3230035.030</a>
1" Filter with 100 mesh .....	<a href="#">3224044</a>	<a href="#">323004.030</a>

### In-line Filter 3/4" & 1/2"

14 Bar pressure capacity. With male BSP thread. 100 L/min.

Description	3/4"	1/2"
Filter with 50 mesh .....	<a href="#">3222033</a>	<a href="#">3222023</a>
Filter with 80 mesh .....	<a href="#">32220335</a>	<a href="#">32220235</a>
Filter with 100 mesh .....	<a href="#">3222034</a>	<a href="#">3222024</a>

### 324 Series & 322 Series Replacement Screens

Suits 3/4" & 1/2" filters	Order Code
50 mesh .....	<a href="#">322003.030</a>
80 mesh .....	<a href="#">3220035.030</a>
100 mesh .....	<a href="#">322004.030</a>

## Mini Suction Filters



Mini Suction Filter, suitable for 12V pumps and low flow applications. Filtering Capacity up to 20l/min.

Description	Order Code
3/4" M BSP, 3/4" Tail, 100 mesh .....	<a href="#">309734</a>
1/2" M BSP Fly-nut, 1/2" Tail, 80 mesh .....	<a href="#">3099535</a>
1/2" M BSP Fly-nut, 1/2" Tail, 100 mesh .....	<a href="#">309954</a>

Replacement Screens	Order Code
50 mesh .....	<a href="#">324003.030</a>
80 mesh .....	<a href="#">3240035.030</a>
100 mesh .....	<a href="#">324004.030</a>





**Straight hose fitting  
with male thread**

Part No.	Thread	Hosetail
103 2008.....	1/4"	8mm
103 2010.....	1/4"	10mm
103 2013.....	1/4"	13mm
103 2108.....	3/8"	8mm
103 2110.....	3/8"	10mm
103 2113.....	3/8"	13mm
103 2115.....	3/8"	16mm
103 2210.....	1/2"	10mm
103 2213.....	1/2"	13mm
103 2215.....	1/2"	16mm
103 2220.....	1/2"	20mm
103 2313.....	3/4"	13mm
103 2315.....	3/4"	16mm
103 2320.....	3/4"	20mm
103 2322.....	3/4"	22mm
103 2325.....	3/4"	25mm
103 2420.....	1"	20mm
103 2422.....	1"	22mm
103 2425.....	1"	25mm
103 2430.....	1"	30mm
103 2432.....	1"	32mm
103 2520.....	1 1/4"	20mm
103 2525.....	1 1/4"	25mm
103 2530.....	1 1/4"	30mm
103 2532.....	1 1/4"	32mm
103 2535.....	1 1/4"	35mm
103 2538.....	1 1/4"	38mm
103 2540.....	1 1/4"	40mm
103 2630.....	1 1/2"	30mm
103 2632.....	1 1/2"	32mm
103 2635.....	1 1/2"	35mm
103 2638.....	1 1/2"	38mm
103 2640.....	1 1/2"	40mm
103 2645.....	1 1/2"	45mm
103 2650.....	1 1/2"	50mm
103 2750.....	2"	50mm
103 2760.....	2"	60mm
103 2860.....	2 1/2"	60mm
103 2975.....	3"	75mm



**90° hose fitting with  
male thread**

Part No.	Thread	Hosetail
113 2113.....	3/8"	13mm
113 2115.....	3/8"	16mm
113 2213.....	1/2"	13mm
113 2215.....	1/2"	16mm
113 2220.....	1/2"	20mm
113 2313.....	3/4"	13mm
113 2315.....	3/4"	16mm
113 2320.....	3/4"	20mm
113 2325.....	3/4"	25mm
113 2420.....	1"	20mm
113 2425.....	1"	25mm
113 2430.....	1"	30mm
113 2432.....	1"	32mm
113 2525.....	1 1/4"	25mm
113 2530.....	1 1/4"	30mm
113 2532.....	1 1/4"	32mm
113 2535.....	1 1/4"	35mm
113 2538.....	1 1/4"	38mm
113 2540.....	1 1/4"	40mm
113 2630.....	1 1/2"	30mm
113 2632.....	1 1/2"	32mm
113 2635.....	1 1/2"	35mm
113 2638.....	1 1/2"	38mm
113 2640.....	1 1/2"	40mm
113 2750.....	2"	50mm
113 2752.....	2"	52mm
113 2960.....	3"	60mm
113 2975.....	3"	75mm



**45° hose fitting with  
male thread**

Part No.	Thread	Hosetail
114 635.....	1 1/2"	35mm
114 640.....	1 1/2"	40mm

# Fittings

## Hosetail Fittings

### Hosetail & Flynut with O-Ring Gasket



Flynut	Hosetail	Gasket
200 2020..... 1/2"	106 211 ..... 11mm 106 213 ..... 13mm	500000.170
200 2030..... 3/4"	106 313 ..... 13mm 106 315 ..... 15mm 106 318 ..... 18mm	G10031
200 2040..... 1"	106 413 ..... 13mm 106 415 ..... 15mm 106 419 ..... 19mm 106 422 ..... 22mm 106 425 ..... 25mm	G10041
200 2050..... 1 1/4"	106 522 ..... 22mm 106 525 ..... 25mm 106 530 ..... 30mm 106 533 ..... 32mm	G10051
200 2060..... 1 1/2"	106 625 ..... 25mm 106 630 ..... 30mm 106 633 ..... 32mm 106 635 ..... 35mm 106 638 ..... 38mm 106 640 ..... 40mm	G10061
200 2070..... 2"	106 740 ..... 40mm 106 745 ..... 45mm 106 750 ..... 50mm	G10071 (x2)
200 2080..... 2 1/2"	106 860 ..... 60mm	G10081 (x2)
200 2090..... 3"	106 960 ..... 60mm 106 975 ..... 75mm	G10091 (x2)

### 90° Hosetail & Flynut with O-Ring Gasket



Flynut	Hosetail	Gasket
200 2020..... 1/2"	116 210 ..... 10mm	500000.170
200 2030..... 3/4"	116 313 ..... 13mm 116 315 ..... 15mm 116 317 ..... 17mm 116 320 ..... 20mm	G10031
200 2040..... 1"	116 415 ..... 15mm 116 420 ..... 20mm 116 425 ..... 25mm	G10041
200 2050..... 1 1/4"	116 522 ..... 22mm 116 525 ..... 25mm 116 530 ..... 30mm 116 533 ..... 32mm	G10051
200 2060..... 1 1/2"	116 625 ..... 25mm 116 630 ..... 30mm 116 633 ..... 32mm 116 635 ..... 35mm 116 638 ..... 38mm 116 640 ..... 40mm	G10061
200 2070..... 2"	116 740 ..... 40mm 116 745 ..... 45mm 116 750 ..... 50mm 116 752 ..... 52mm	G10071 (x2)
200 2080..... 2 1/2"	116 860 ..... 60mm	G10081 (x2)
200 2090..... 3"	116 960 ..... 60mm 116 975 ..... 75mm	G10091 (x2)

### Hosetail & Flynut with Flat Face Gasket



Flynut	Hosetail	Gasket
200 010..... 3/8"	105 110 .....10mm 105 111 .....11mm	424 190
200 2020..... 1/2"	105 210 .....10mm 105 213 .....13mm	G40012
200 2030..... 3/4"	105 313 .....13mm 105 315 .....15mm 105 320 .....20mm	G40013
200 2040..... 1"	105 420 .....20mm 105 425 .....25mm	G40014
200 2050..... 1 1/4"	105 530 .....30mm	G40015
200 2060..... 1 1/2"	105640 .....40mm	G40004

### 90° Hosetail & Flynut with Flat Face Gasket



Flynut	Hosetail	Gasket
200 2020..... 1/2"	115 210 .....10mm	G40012
200 2030..... 3/4"	115 313 .....13mm 115 320 .....15mm	G40013
200 2040..... 1"	115 425 .....25mm	G40014
200 2050..... 1 1/4"	115 530 .....30mm	G40015
200 2060..... 1 1/2"	115 640 .....40mm	G40004

### 45° Hosetail & Flynut with O-Ring Gasket



Flynut	Hosetail	Gasket
200 2020..... 1/2"	117 213 .....13mm	500000.170
200 2050..... 1 1/4"	117 530 .....30mm 117 532 .....32mm	G10051
200 2060..... 1 1/2"	117 630 .....30mm 117 635 .....35mm 117 640 .....40mm	G10061
200 2070..... 2"	117 745 .....45mm 117 750 .....50mm	G10071 (x2)

# Fittings

## Threaded Fittings



**90° Male to Female**

Part No.	Thread	Gasket
126 2022.....	1/2"	G10041
126 2033.....	3/4"	4062000.060
126 2044.....	1"	454234.080
126 2055.....	1 1/4"	G10052
126 2066.....	1 1/2"	G10062
126 2077.....	2"	G10073

**Assembly diagram  
for fittings with  
O-Ring seal**

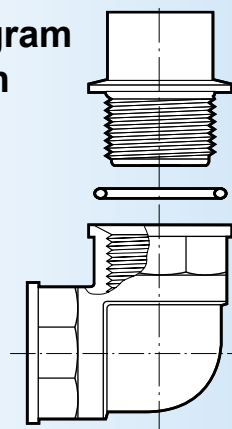

**90° Female to Female**

Part No.	Thread	Gasket
120 2022.....	1/2"	G10041
120 2033.....	3/4"	4062000.060
120 2044.....	1"	454234.080
120 2055.....	1 1/4"	G10052
120 2066.....	1 1/2"	G10062
120 2077.....	2"	G10073



**90° Male to Male**

Part No.	Thread
123 044.....	1"
123 055.....	1 1/4"
123 2077.....	2"

**Female Tee**

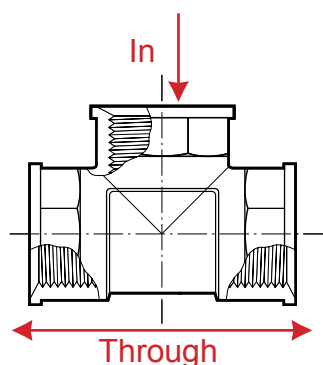

Part No.	In Thread	Through Thread	Gasket
130 2020.....	1/2"	1/2"	G10041
130 2023.....	1/2"	3/4"	4062000.060
			G10041
130 2030.....	3/4"	3/4"	4062000.060
130 2040.....	1"	1"	454234.080
130 2050.....	1 1/4"	1 1/4"	G10052
130 2060.....	1 1/2"	1 1/2"	G10062
130 2070.....	2"	2"	G10073



## Threaded Fittings



### Male Tee

Part No.	Thread
131 2050.....	1 1/4"
131 2060.....	1 1/2"
131 2070.....	2"



### Female / Male Tee

Part No.	Thread
132 040.....	1"
132 050.....	1 1/4"
132 2070.....	2"

### Male / Female Tee

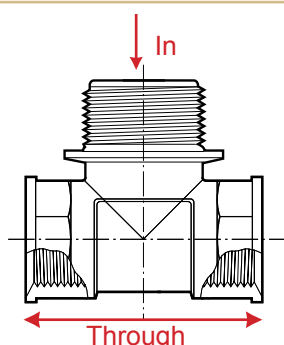

Part No.	In Thread	Through Thread
133 024.....	1"	1/2"
133 034.....	1 1/4"	3/4"



### Symmetrical Nipple

Part No.	Thread	Thread length
250 2020.....	1/2"	18mm/18mm
250 2030.....	3/4"	22mm/22mm
250 2040.....	1"	22mm/22mm
250 2050.....	1 1/4"	24mm/24mm
250 2060.....	1 1/2"	24mm/24mm
250 2070.....	2"	27mm/27mm
250 2080.....	2 1/2"	32mm/32mm
250 2090.....	3"	35mm/35mm



### Bulkhead Nipple

Part No.	Thread	Thread length
250 2021.....	1/2"	38mm/18mm
250 2031.....	3/4"	40mm/22mm
250 2041.....	1"	45mm/22mm
250 2051.....	1 1/4"	54mm/24mm
250 2061.....	1 1/2"	50mm/24mm
250 2071.....	2"	50mm/27mm
250 2081.....	2 1/2"	65mm/32mm



### Threaded Barrel Nipple

Part No.	Thread	Thread length
230 530.....	3/4"	47mm
230 540.....	1"	51mm
230 550.....	1 1/4"	33.5mm
230 551.....	1 1/4"	47.5mm
230 560.....	1 1/2"	46mm
230 570.....	2"	69mm



### Threaded Coupling

Part No.	Thread
230 2010.....	3/8"
230 2020.....	1/2"
230 2030.....	3/4"
230 2040.....	1"
230 2050.....	1 1/4"
230 2060.....	1 1/2"
230 2070.....	2"

# Fittings

## Threaded Fittings



**Male / Male  
Reducing Nipple**

Part No.	Thread 1	Thread 2
240 2020.....	1/2"	1/4"
240 2021.....	1/2"	3/8"
240 2031.....	3/4"	3/8"
240 2032.....	3/4"	1/2"
240 2042.....	1"	1/2"
240 2043.....	1"	3/4"
240 2053.....	1 1/4"	3/4"
240 2054.....	1 1/4"	1"
240 2064.....	1 1/2"	1"
240 2065.....	1 1/2"	1 1/4"
240 2075.....	2"	1 1/4"
240 2076.....	2"	1 1/2"
240 2097.....	3"	2"
240 2098.....	3"	2 1/2"



**Female / Female  
Reducing Nipple**

Part No.	Thread 1	Thread 2
235 2010.....	3/8"	1/4"
235 2020.....	1/2"	1/4"
235 2021.....	1/2"	3/8"
235 2031.....	3/4"	3/8"
235 2032.....	3/4"	1/2"
235 2042.....	1"	1/2"
235 2043.....	1"	3/4"
235 2053.....	1 1/4"	3/4"
235 2054.....	1 1/4"	1"
235 2064.....	1 1/2"	1"
235 2065.....	1 1/2"	1 1/4"
235 2075.....	2"	1 1/4"
235 2076.....	2"	1 1/2"



**Male / Female  
Reducing Nipple**

Part No.	M Thread	F Thread
245 010.....	3/8"	1/4"
245 2032.....	3/4"	1/2"
245 2042.....	1"	1/2"
245 2043.....	1"	3/4"
245 2053.....	1 1/4"	3/4"
245 2054.....	1 1/4"	1"
245 2064.....	1 1/2"	1"
245 2065.....	1 1/2"	1 1/4"
245 2075.....	2"	1 1/4"
245 2076.....	2"	1 1/2"



**Female / Male  
Reducing Nipple**

Part No.	M Thread	F Thread
245 2001.....	3/8"	1/4"
245 2002.....	1/2"	1/4"
245 2012.....	1/2"	3/8"
245 2013.....	3/4"	3/8"
245 2023.....	3/4"	1/2"
245 2024.....	1"	1/2"
245 2034.....	1"	3/4"
245 2035.....	1 1/4"	3/4"
245 2045.....	1 1/4"	1"
245 2046.....	1 1/2"	1"
245 2056.....	1 1/2"	1 1/4"
245 2057.....	2"	1 1/4"
245 2067.....	2"	1 1/2"
245 079.....	3"	2"



**Male / Female  
Threaded Coupling**

Part No.	M Thread	F Thread
245 2022.....	1/2"	1/2"
245 2033.....	3/4"	3/4"
245 2044.....	1"	1"
245 2055.....	1 1/4"	1 1/4"
245 2066.....	1 1/2"	1 1/2"
245 2077.....	2"	2"





### Fly Nuts

Depth

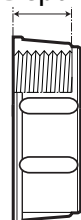

Part No.	Thread	Depth
200 010.....	3/8"	14mm
200 2020.....	1/2"	13mm
200 2024.....	1/2"	15mm
200 2030.....	3/4"	13.5mm
200 2040.....	1"	17.5mm
200 2050.....	1 1/4"	18mm
200 2060.....	1 1/2"	19mm
200 2070.....	2"	19mm
200 2080.....	2 1/2"	20mm
200 2090.....	3"	25.5mm



### Locking Rings

Depth



Part No.	Thread	Depth
205 010.....	3/8"	13mm
205 2020.....	1/2"	13mm
205 2030.....	3/4"	13mm
205 2040.....	1"	15.5mm
205 2050.....	1 1/4"	14.3mm
205 2060.....	1 1/2"	15mm
205 2070.....	2"	19.5mm
205 2080.....	2 1/2"	20mm
205 2090.....	3"	22mm



### Blanking Caps

Depth

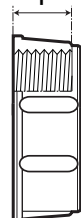

Part No.	Thread
210 005.....	1/4"
210 010.....	3/8"
210 2020.....	1/2"
210 2030.....	3/4"
210 2040.....	1"
210 2050.....	1 1/4"
210 2060.....	1 1/2"
210 2070.....	2"
210 2080.....	2 1/2"
210 2090.....	3"



### Male Threaded Plugs

Part No.	Thread
215 001.....	1/4"
215 010.....	3/8"
215 020.....	1/2"
215 030.....	3/4"
215 040.....	1"
215 050.....	1 1/4"



### Reversible Bulkhead Fitting

Can be fitted with the elbow inside or outside the tank.

Description

Order Code

1/2" BSP M Bulkhead fitting with gasket .....	<a href="#">118215G</a>
3/4" BSP M Bulkhead fitting with gasket .....	<a href="#">118319G</a>
1" BSP M Bulkhead fitting with gasket .....	<a href="#">118426G</a>



### Straight Bulkhead Hose Fitting

One piece hosetail with flynut complete with gasket.

Description

Order Code

1" BSP M fitting .....	<a href="#">108425G</a>
------------------------	-------------------------

# Fittings

## General Fittings



### Drain Outlets

Used with matching flynut and hosedtail for tank drains.  
Comes complete with gasket.

Description	Order Code
1/2" .....	DO12
3/4" .....	DO34
1" .....	DO1
1 1/4" .....	D114
1 1/2" .....	D112
2" .....	DO2



### Non Return Valve

Used for inhibiting backflow, eg. to maintain integrity of fresh water to chemical mixes.

Description	Order Code
1 1/4" BSP F .....	504010
1 1/2" BSP F .....	504015
2" BSP F in, 2" BSP M out.....	504029



### Antivortex Tank Outlet Assembly

Avoid sucking air - especially important for high volume pumps.

Description	Order Code
1 1/4" Complete with gasket .....	AV114
1 1/2" Complete with gasket .....	AV112
2" Complete with gasket .....	AV2

### Gaskets

#### To suit hose fitting with O-Ring

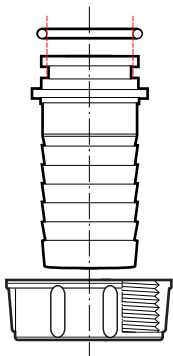

Part No.	Thread
400040.030.....	3/8"
500000.170.....	1/2"
G10031.....	3/4"
G10041.....	1"
G10051.....	1 1/4"
G10061.....	1 1/2"
G10071.....	2"
G10081.....	2 1/2"
G10091.....	3"

#### To suit hose fitting with Flat Face Seal

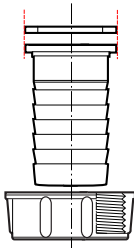

Part No.	Thread
424190.....	3/8"
G40012.....	1/2"
G40013.....	3/4"
G40014.....	1"
G40015.....	1 1/4"

#### To suit threaded fitting with O-Ring Seal

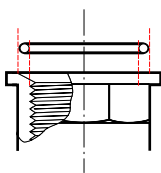

Part No.	Thread
G10041.....	1/2"
4062000.060.....	3/4"
454234.080.....	1"
G10052.....	1 1/4"
G10062.....	1 1/2"
G10073.....	2"
G10082.....	2 1/2"
G10092.....	3"



### Gaskets

#### To suit Blanking Caps

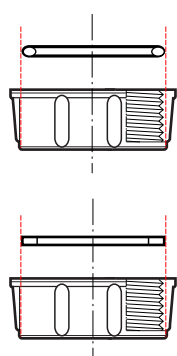

Part No.	Thread
003600 (O-Ring) .....	3/8"
G10020 (O-Ring) .....	1/2"
G40013 .....	3/4"
G40014 .....	1"
G40015 .....	1 1/4"
G40004 .....	1 1/2"
G40005 .....	2"
G40010 .....	2 1/2"
G40007 .....	3"

### Gaskets

#### To suit male bulkheads with Flat Face Seal

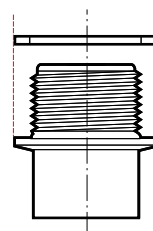

Part No.	Thread
G40002 .....	1/2"
G40015 .....	3/4"
G40004 .....	1"
G40005 .....	1 1/4"
G40006 .....	1 1/2"
G40007 .....	2"
G40008 .....	2 1/2"
G40009 .....	3"

## Cam Locking Couplings

	Size						
	1/2"	3/4"	1"	1 1/4"	1 1/2"	2"	3"
A	18103A2	18103A	18104A	18105A	18106A	18107A	18109A
B	18103B2	18103B	18104B	18105B	18106B	18107B	18109B
C	18103C2	18103C	18104C	18105C 18105C30	18106C 18106C40	18107C	18109C
D	18103D2	18103D	18104D	18105D	18106D	18107D	18109D
E	18103E2	18103E	18104E	18105E 18105E30	18106E 18106E40	18107E	18109E
F	18103F2	18103F	18104F	18105F	18106F	18107F	18109F
G		18103G	18104G	18105G	18106G	18107G	18109G
H		18103H	18104H	18105H	18106H	18107H	18109H



A



B



C



D



E



F



G



H

## Agitators



### Super mix high capacity tank agitator

Improves consistency of your tank contents. Especially suited to vineyard and orchard sprayers.

Description

Order Code

Super mix high capacity tank agitator.....502053

# Fittings

## Agitators



### High capacity tank agitator

Typically multiplies tank agitation by 7 times. Suited to boom spraying. Swivel mounting to suit curved tanks. Please check with our staff for correct nozzle for your application.

Description	Order Code
High capacity tank agitator .....	<a href="#">502069</a>



### Compact tank agitator

To suit smaller tanks such as three point linkage mounted sprayers.

Description	Order Code
Compact tank agitator .....	<a href="#">5022043</a>

## Tank Fittings



### Main tank rinse nozzles

- A: ARAG tank rinse nozzle: 360° coverage to 3m.  
1/2" F BSP fitting.
- B: POLMAC tank rinse nozzle: 360° coverage to 3m.  
1/2" M BSP fitting constructed using anti-corrosive material.

Description	Order Code
ARAG main tank rinse nozzle.....	<a href="#">510120</a>
POLMAC main tank rinse nozzle.....	<a href="#">P63408399</a>



### Container rinsing nozzles

- A: ARAG container rinsing nozzle: 360° coverage.  
1/2" F BSP fitting.
- B: POLMAC container rinsing nozzle: 360° coverage.  
1/2" M BSP fitting constructed using anti-corrosive material.

Description	Order Code
ARAG container rinsing nozzle.....	<a href="#">510110</a>
POLMAC container rinsing nozzle.....	<a href="#">P63408499</a>



### Safety Valve

To suit ARAG container rinsing nozzles.

Description	Order Code
Safety Valve.....	<a href="#">510100</a>



### Venturi

Low pressure venturi used for chemical filling. Used with many chemical hoppers. 10mm requires 100l/min, 13mm requires 160l/min.

Description	Order Code
Venturi 10mm .....	<a href="#">135542</a>
Venturi 13mm .....	<a href="#">135543</a>



### Remote operated tank drain valve

Used for draining tank contents. Operated from the top of the tank.

Description	Order Code
2' Remote tank drain valve .....	<a href="#">452107</a>



### Hinged Tank Lid and Ring Set

Description	Order Code
486mm hinged lid .....	<a href="#">356060</a>
367mm hinged lid .....	<a href="#">356040</a>

### Replacement Lids

Threaded lids with a fixed labyrinth breather.  
(Outside diameter measurement)



Description	Order Code
454mm .....	<a href="#">3522261</a>
355mm .....	<a href="#">3522241</a>
250mm .....	<a href="#">3522221</a>

#### Lid Ring

454mm .....	<a href="#">3502460</a>
355mm .....	<a href="#">3502440</a>
250mm .....	<a href="#">3502420</a>



### Replacement Lid Baskets

(Outside diameter measurement)

Description	Order Code
400mm Basket.....	<a href="#">300134</a>
305mm Basket.....	<a href="#">300120</a>
203mm Basket.....	<a href="#">300116</a>

# Fittings

## Tank Fittings



### Powder Mixer

For use mixing powder and granules in filling baskets.

Description	Order Code
Powder and granule mixer.....	<a href="#">502001</a>

## Special Fittings



### Swivel Fittings

With universal quick release fittings.

Description	Order Code
Single swivel with 1/4" BSP thread.....	<a href="#">404072</a>
Single swivel with 3/8" BSP thread.....	<a href="#">404082</a>
Double swivel with 1/4" BSP thread .....	<a href="#">404172</a>
Double swivel with 3/8" BSP thread .....	<a href="#">404182</a>
Double swivel with 3/8" BSP thread & threaded caps .....	<a href="#">404180</a>



### High Pressure Swivel Fittings

With metal threaded caps.

Description	Order Code
Single swivel with 1/4" M BSP thread.....	<a href="#">004750</a>
Double swivel with 1/4" M BSP thread .....	<a href="#">004760</a>



### Quick Fitting Adaptors

Description	Order Code
1/4" Male thread .....	<a href="#">400270</a>
1/4" Female thread .....	<a href="#">400275N</a>



### Hose Droppers

1/4" Male thread & quick release cap.

Description	Order Code
380mm long.....	<a href="#">430201</a>
610mm long.....	<a href="#">430202</a>





### Easy Mixer - 30L

Used for mixing liquid, powder and granular chemicals. Its symmetrical structure makes it easy to install on most sprayers. Fitted with a hinged cover which does not interfere with the controls. Features include: Quick funnel, nozzle for dissolving products, safety valve, support frame and an internal inspection port.

Description	Order Code
30L Easy mixer .....	<a href="#">P001841DR</a>



### Ecological Mixer - 50L

Used for mixing liquid, powder and granular chemicals. Fitted with a hinged cover. Features include: Quick funnel, nozzle for dissolving products, safety valve, support frame and an internal inspection port.

Description	Order Code
50L Ecological mixer .....	<a href="#">P001812DR</a>



### Mixer Support Jack

Made of galvanised steel, it can be applied on any Polmac mixer for installation on any type of sprayer. It can be extended up to a maximum height of 75cm. The returning action is facilitated by a return spring, and is fitted with a safety hook for the closed position.

Description	Order Code
Mixer support jack .....	<a href="#">P63411399</a>

# Appendix 1

## Spray Nozzle Chart

Press.L/min			Speed in km/h @50cm Nozzle Spacings																
Bar /nozzle			8	10	12	14	16	18	20	22	24	26	28	30	32	34	36	38	40
Orange #01	1	0.23	35	28	32	20	17	15	14	13	12	11	10	9	9	8	8	7	7
	1.5	0.28	42	34	28	24	21	19	17	15	14	13	12	11	11	10	9	9	8
	2	0.32	48	38	32	27	24	21	19	17	16	15	14	13	12	11	11	10	10
	2.5	0.36	54	43	36	31	27	24	22	20	18	17	15	14	14	13	12	11	11
	3	0.39	59	47	39	33	29	26	23	21	20	18	17	16	15	14	13	12	12
	3.5	0.42	63	50	42	36	32	28	25	23	21	19	18	17	16	15	14	13	13
	4	0.45	68	54	45	39	34	30	27	25	23	21	19	18	17	16	15	14	14
	4.5	0.48	72	58	48	41	36	32	29	26	24	22	21	19	18	17	16	15	14
	5	0.50	75	60	50	43	38	33	30	27	25	23	21	20	19	18	17	16	15
	5.5	0.53	80	64	53	45	40	35	32	29	27	24	23	21	20	19	18	17	16
	6	0.55	83	66	55	47	41	37	33	30	28	25	24	22	21	19	18	17	17
Green #015	1	0.34	51	41	34	29	26	23	20	19	17	16	15	14	13	12	11	11	10
	1.5	0.42	63	50	42	36	32	28	25	23	21	19	18	17	16	15	14	13	13
	2	0.48	72	58	48	41	36	32	29	26	24	22	21	19	18	17	16	15	14
	2.5	0.54	81	65	54	46	41	36	32	29	27	25	23	22	20	19	18	17	16
	3	0.59	89	71	59	51	44	39	35	32	30	27	25	24	22	21	20	19	18
	3.5	0.64	96	77	64	55	48	43	38	35	32	30	27	26	24	23	21	20	19
	4	0.68	102	82	68	58	51	45	41	37	34	31	29	27	26	24	23	21	20
	4.5	0.72	108	86	72	62	54	48	43	39	36	33	31	29	27	25	24	23	22
	5	0.76	114	91	76	65	57	51	46	41	38	35	33	30	29	27	25	24	23
	5.5	0.8	120	96	80	69	60	53	48	44	40	37	34	32	30	28	27	25	24
	6	0.83	125	100	83	71	62	55	50	45	42	38	36	33	31	29	28	26	25
Yellow #02	1	0.46	69	55	46	39	35	31	28	25	23	21	20	18	17	16	15	15	14
	1.5	0.56	84	67	56	48	42	37	34	31	28	26	24	22	21	20	19	18	17
	2	0.65	98	78	65	56	49	43	39	35	33	30	28	26	24	23	22	21	20
	2.5	0.71	108	86	72	62	54	48	43	39	36	33	31	29	26	25	24	23	22
	3	0.79	119	95	79	68	59	53	47	43	40	36	34	32	30	28	26	25	24
	3.5	0.85	128	102	85	73	64	57	51	46	43	39	36	34	32	30	28	27	26
	4	0.91	139	109	91	78	68	61	55	50	46	42	39	36	34	32	30	29	27
	4.5	0.97	146	116	97	83	73	65	58	53	49	45	42	39	36	34	32	31	29
	5	1.02	153	122	102	87	77	68	61	56	51	47	44	41	38	36	34	32	31
	5.5	1.07	161	128	107	92	80	71	64	58	54	49	46	43	40	38	36	34	32
	6	1.12	168	132	112	96	84	75	67	61	56	52	48	45	42	40	37	35	34
Lilac #025	1	0.57	86	68	57	49	43	38	34	31	29	26	24	23	21	20	19	18	17
	1.5	0.70	105	84	70	60	53	47	42	38	35	32	30	28	26	25	23	22	21
	2	0.96	144	115	96	82	72	64	58	52	48	44	41	38	36	34	32	30	29
	2.5	0.90	135	108	90	77	68	60	54	49	45	42	39	36	34	32	30	28	27
	3	0.99	149	119	99	85	74	66	59	54	50	46	42	40	37	35	33	31	30
	3.5	1.07	161	128	107	92	80	71	64	58	54	49	46	43	40	38	36	34	32
	4	1.14	171	137	114	98	86	76	68	62	57	53	49	46	43	40	38	36	34
	4.5	1.21	182	145	121	104	91	81	73	66	61	56	52	48	45	43	40	38	36
	5	1.28	192	154	128	110	96	85	77	70	64	59	55	51	48	45	43	40	38
	5.5	1.34	201	161	134	115	101	89	80	73	67	62	57	54	50	47	45	42	40
	6	1.40	210	168	140	120	105	93	84	76	70	65	60	56	53	49	47	44	42
Blue #03	1	0.68	102	82	68	58	51	45	41	37	34	31	29	27	26	24	23	21	20
	1.5	0.83	125	100	83	71	62	55	50	45	42	38	36	33	31	29	28	26	25
	2	0.96	144	115	96	82	72	64	58	52	48	44	41	38	36	34	32	20	29
	2.5	1.08	162	130	108	93	81	72	65	59	54	50	46	43	41	38	36	34	32
	3	1.18	177	142	118	101	89	79	71	64	59	54	51	47	44	42	39	37	35
	3.5	1.27	191	152	127	109	95	85	76	69	65	59	54	51	48	45	42	40	38
	4	1.36	204	163	136	117	102	91	82	74	68	63	58	54	51	48	45	43	41
	4.5	1.45	218	174	145	124	109	97	87	79	73	67	62	58	54	51	48	46	44
	5	1.52	228	182	152	130	114	101	91	83	76	70	65	61	57	54	51	48	46
	5.5	1.60	240	192	160	137	120	107	96	87	80	74	69	64	60	56	53	51	48
	6	1.67	251	200	167	143	125	111	100	91	84	77	72	67	63	59	56	53	50

## Spray Nozzle Chart (cont.)

Press.L/min			Speed in km/h @50cm Nozzle Spacings																
Bar /nozzle			8	10	12	14	16	18	20	22	24	26	28	30	32	34	36	38	40
Red #04	1	0.91	137	109	91	78	68	61	55	50	46	42	39	36	34	32	20	29	27
	1.5	1.12	168	134	112	96	84	75	67	61	56	52	48	45	42	40	37	35	34
	2	1.29	194	155	129	111	97	86	77	70	65	60	55	52	48	46	43	41	39
	2.5	1.44	216	173	144	123	108	96	86	79	72	66	62	58	54	51	48	45	43
	3	1.58	237	190	158	135	119	105	95	86	79	73	68	63	59	56	53	50	47
	3.5	1.71	257	205	171	147	128	114	103	93	86	79	73	68	64	60	57	54	51
	4	1.82	273	218	182	156	137	121	109	99	91	84	78	73	68	64	61	57	55
	4.5	1.94	291	233	194	166	146	129	116	106	97	90	83	78	73	68	65	61	58
	5	2.04	306	245	205	175	153	136	122	111	102	94	87	82	77	72	68	64	61
	5.5	2.14	321	257	214	183	161	143	128	117	107	99	92	86	80	76	71	68	64
	6	2.23	335	268	223	191	167	149	134	122	112	103	96	89	84	79	74	70	67
Brown #05	1	1.14	171	137	114	98	86	76	68	62	57	53	49	46	43	40	38	36	34
	1.5	1.39	209	167	139	119	103	93	83	76	70	64	60	56	52	49	46	44	42
	2	1.61	242	193	161	138	121	107	97	88	81	74	69	64	60	57	54	51	48
	2.5	1.80	270	216	180	154	135	120	108	98	90	83	77	72	68	64	60	57	54
	3	1.97	296	236	197	169	148	131	118	107	99	91	84	79	74	70	66	62	59
	3.5	2.13	320	256	213	183	160	142	128	116	107	98	91	85	80	75	71	67	64
	4	2.27	341	272	227	195	170	151	136	124	114	105	97	91	85	80	76	72	68
	4.5	2.41	362	289	241	207	181	161	145	131	121	111	103	96	90	85	80	76	72
	5	2.54	381	305	254	218	191	169	152	139	127	117	109	102	95	90	85	80	76
	5.5	2.67	401	320	267	229	200	178	160	146	134	123	114	107	100	94	89	84	80
	6	2.79	419	335	279	239	209	186	167	152	140	129	120	112	105	98	93	88	84
Grey #06	1	1.37	206	164	137	117	103	91	82	75	69	63	59	55	51	48	46	43	41
	1.5	1.68	252	202	168	144	126	112	101	92	84	78	72	67	63	59	56	53	50
	2	1.94	291	233	194	166	146	129	116	106	97	90	83	78	73	68	65	61	58
	2.5	2.16	324	259	216	185	162	144	130	118	108	100	93	86	81	76	71	68	65
	3	2.37	356	284	237	203	178	158	142	129	119	109	102	95	89	84	79	75	71
	3.5	2.56	384	307	256	219	192	171	154	140	128	118	110	102	96	90	85	81	77
	4	2.74	411	329	274	235	206	183	164	149	137	126	117	110	103	97	91	87	82
	4.5	2.90	435	348	290	249	218	193	174	158	145	134	124	116	109	102	97	97	92
	5	3.06	459	367	306	262	230	204	184	167	153	141	131	122	115	108	102	97	92
	5.5	3.21	482	385	321	275	241	214	193	175	161	148	138	128	120	113	107	101	96
	6	3.35	503	402	335	287	251	223	201	183	168	155	144	134	126	118	112	106	101
White #08	1	1.82	273	218	182	156	137	121	109	99	91	84	78	73	68	64	61	57	55
	1.5	2.23	335	268	223	191	167	149	134	122	112	103	96	89	84	79	74	70	67
	2	2.58	387	310	258	221	194	172	155	141	129	119	111	103	97	91	86	81	77
	2.5	2.88	432	346	288	247	216	192	173	157	144	133	123	115	108	102	96	91	86
	3	3.16	474	379	316	271	237	211	190	172	158	146	135	126	119	112	105	100	95
	3.5	3.41	512	409	341	292	256	227	205	186	171	157	146	136	128	120	114	108	102
	4	3.65	548	438	365	313	274	243	219	199	183	168	156	146	137	129	122	115	110
	4.5	3.86	579	463	386	331	290	257	232	211	193	178	165	154	145	136	129	122	116
	5	4.08	612	490	408	350	306	272	245	223	204	188	175	163	153	144	136	129	122
	5.5	4.28	642	514	428	367	321	285	257	233	214	198	183	171	161	151	143	135	128
	6	4.47	671	536	447	383	335	298	268	244	224	206	192	179	168	158	149	141	134



# Conditions of Sale

## Terms and Conditions of Sale of Topcon Precision Agriculture

The following condensed terms and conditions of sale are the most referred to.

The full terms and conditions of sale are available on request from Topcon Precision Agriculture and are contained on the reverse side of all our invoices.

- Payment terms are strictly cash before dispatch unless otherwise agreed to in writing.
- Payment may be made by any major Credit Card, Cheque, Cash or direct on line to our account.
- Property in the goods the subject of any orders made on this account remain the property of the supplier until payment has been made in full.
- The risk of the goods passes to the purchaser at the point of dispatch.
- Freight and insurance are the purchasers responsibility.
- All prices are ex-shelf. Delivery, packing and insurance, where applicable, may incur additional cost.
- Shortages or discrepancies must be reported within 24 hours of receipt.
- Suitability for the intended purpose is the responsibility of the purchaser.
- Verbally agreed, mailed, faxed and emailed orders from the customer are regarded as suitable evidence of a firm order.
- By placing a firm order, the customer authorises Topcon Precision Agriculture to debit the quoted credit card or to charge to a pre-approved credit account for these purchases at time of dispatch or as otherwise advised in writing.
- Customers with credit card accounts authorize the supplier to securely retain credit card details on file and debit this card for all purchases at the time of dispatch.